

REVISION HISTORY				
ZONE	REV	DESCRIPTION	DATE	APPROVED
All	1	Released	10/31/2022	KLD

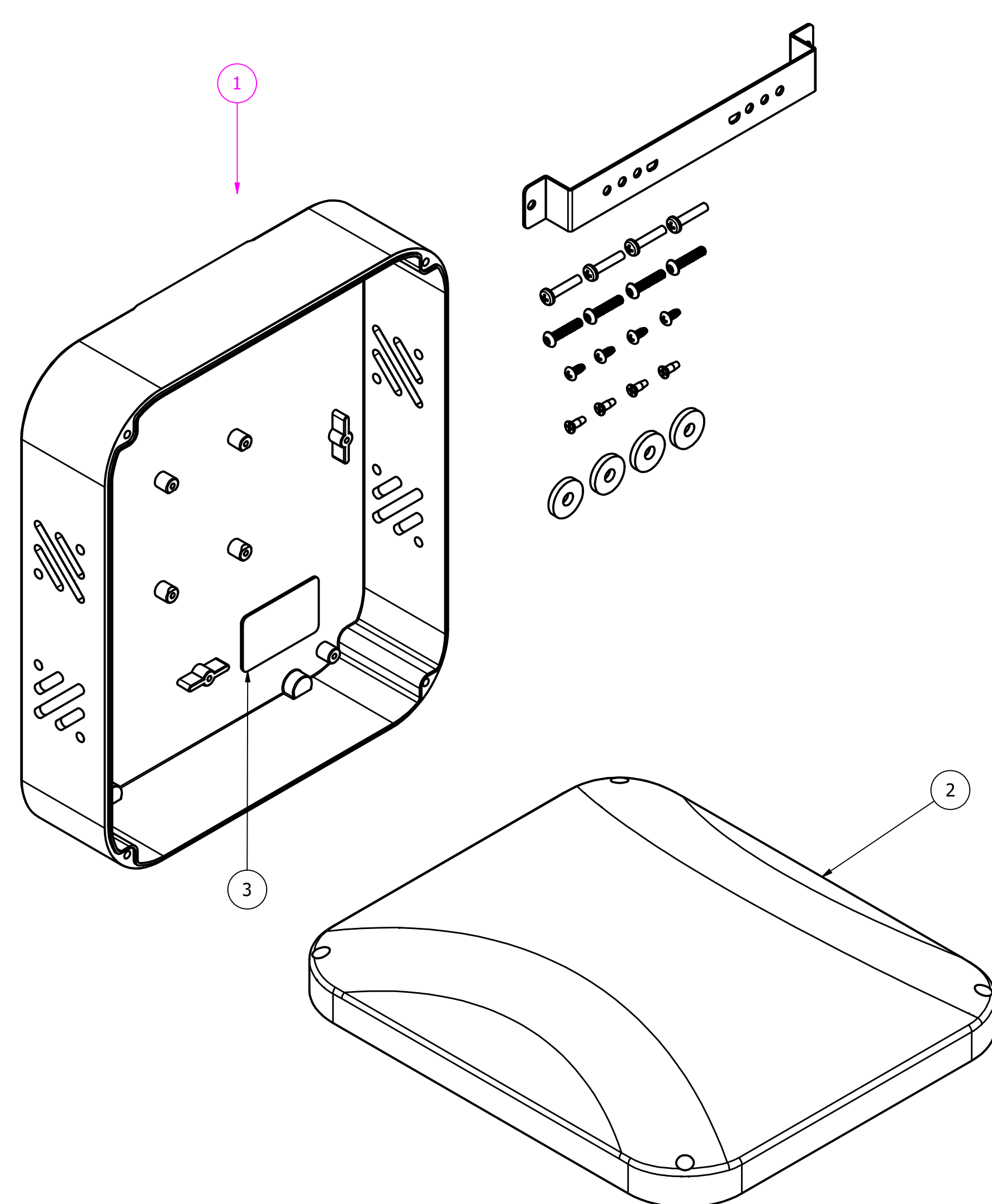

PARTS LIST			
ITEM	QTY	PART NUMBER	DESCRIPTION
1	1	TBD	1014-IND-V Base
2	1	BUD P/N 48792-C-IND	1014-IND Lid
3	1	Oberon Label	
9	1	4711	

DRAWN KLD	10/31/2022	Oberon, Inc. - 1315 S. Allen St. - State College, PA 16801		
CHECKED KLD	10/31/2022	TITLE		
QA		Model 1014-IND		
MFG KLD	10/31/2022	SIZE C	DWG NO 1014-IND for CUT	REV 1
APPROVED KLD	10/31/2022	SCALE	SHEET 2 OF 4	
TOLERANCE:				
.0 = +/- .030				
.00 = +/- .015				
.000 = +/- .005				

NOTE: All materials used in the construction of Oberon products must be RoHS compliant and meet RoHS2 Directive 2011/65/EU. Contact Oberon engineering if RoHS compliant materials are not available.