

Installation Instructions

Clik-Nut[®] Hardware Kit

Clik-Nut[®]

Redefining the Cage Nut

- Fast installation saves you time
- Easy, tool-less attachment and removal
- Use anywhere you would use standard cage nuts
- Available in M6, #12-24 and #10-32 thread sets
- Fits .375" (9.5 mm) square hole
- Grip range 16 ga to 12 ga, .060" to .105" (1.52 mm to 2.67 mm panel thickness)
- Includes mounting screws

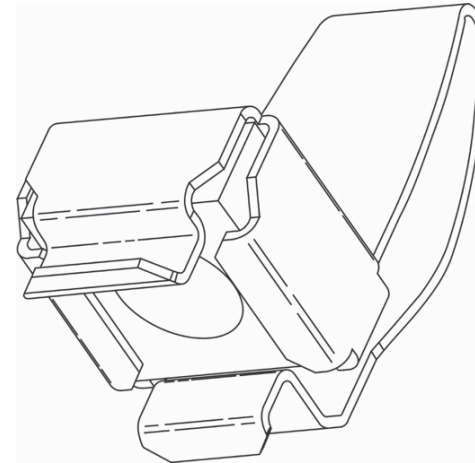

Performs like a traditional cage nut without the hassle.

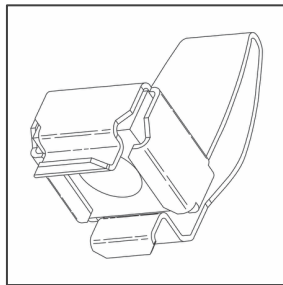

Hold Clik-Nut by the tab. Squeezing the tab allows the nut to be inserted and/or removed from mounting holes.

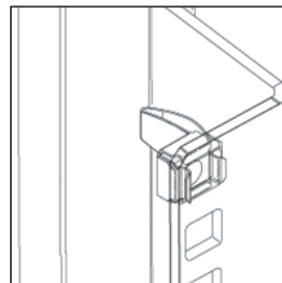

Orient tab away from EIA space.

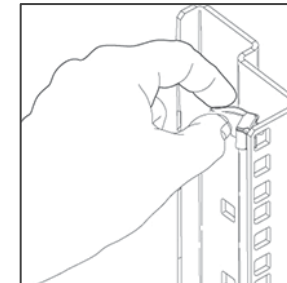

Align, squeeze, insert and release. To mount a panel, place fasteners at the same location/height/U space on opposite rails. Typically, a minimum of four Click-Nuts and screws should be used per panel. Attach panel with included screw.



IIS-76543 07/22/2016, Rev. 2, CPI/JJC
800-834-4969 (USA & Canada) • www.chatsworth.com • techsupport@chatsworth.com
For international phone numbers, see our website or contact CPI Tech Support.

This drawing contains proprietary and confidential information and is protected by U.S. and international law. Unauthorized reproduction, disclosure or use of the drawing or the information therein is expressly forbidden except as agreed to in writing by Chatsworth Products, Inc.