

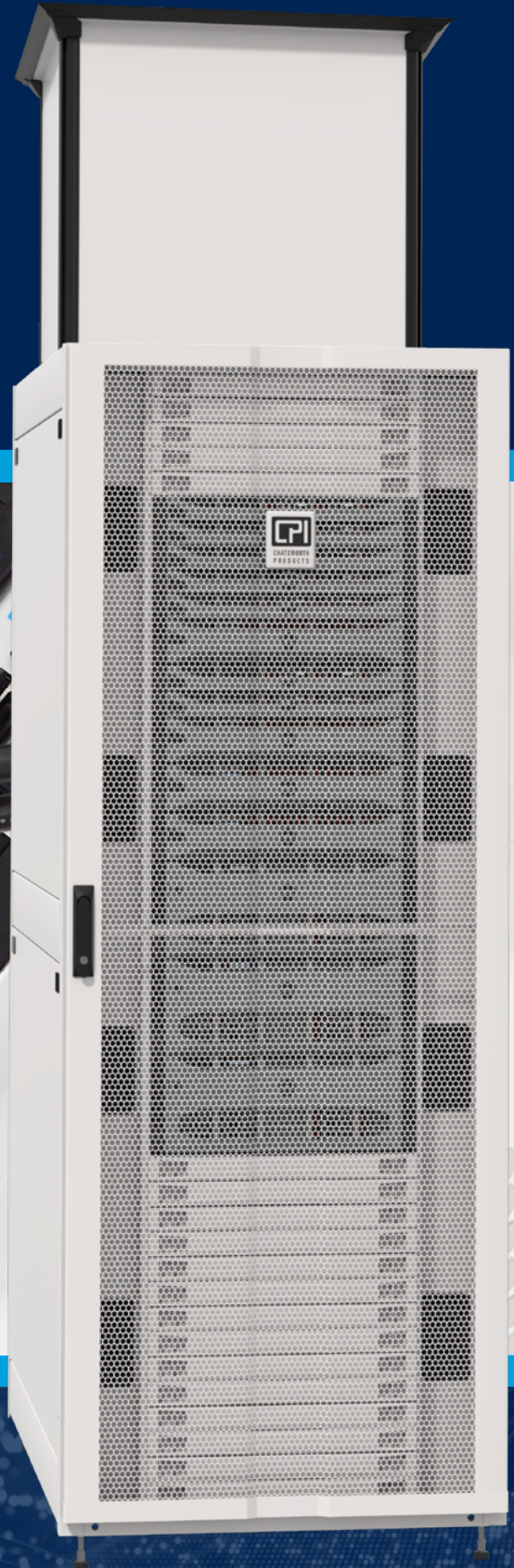

CHATSWORTH
PRODUCTS

Power and Cabinet Ordering Guide



[chatsworth.com](https://www.chatsworth.com)

Steps to Creating Your Own Power and Cabinet Solution

This ordering guide is designed to select all the components you need to create a complete power and cabinet solution. Follow these steps to create and customize your own power and cabinet solution.



Manage power with intelligence.
Select a PDU



Ensure uptime and protect IT assets.
Add rack-mountable UPS



Monitor the environment proactively.
Add environmental monitoring



Protect equipment electronically.
Add electronic locks



Optimize systems remotely.
Add DCIM software



Support equipment with strength.
Select a cabinet



Organize cables with flexibility.
Add cable management



Control airflow effectively.
Add airflow management

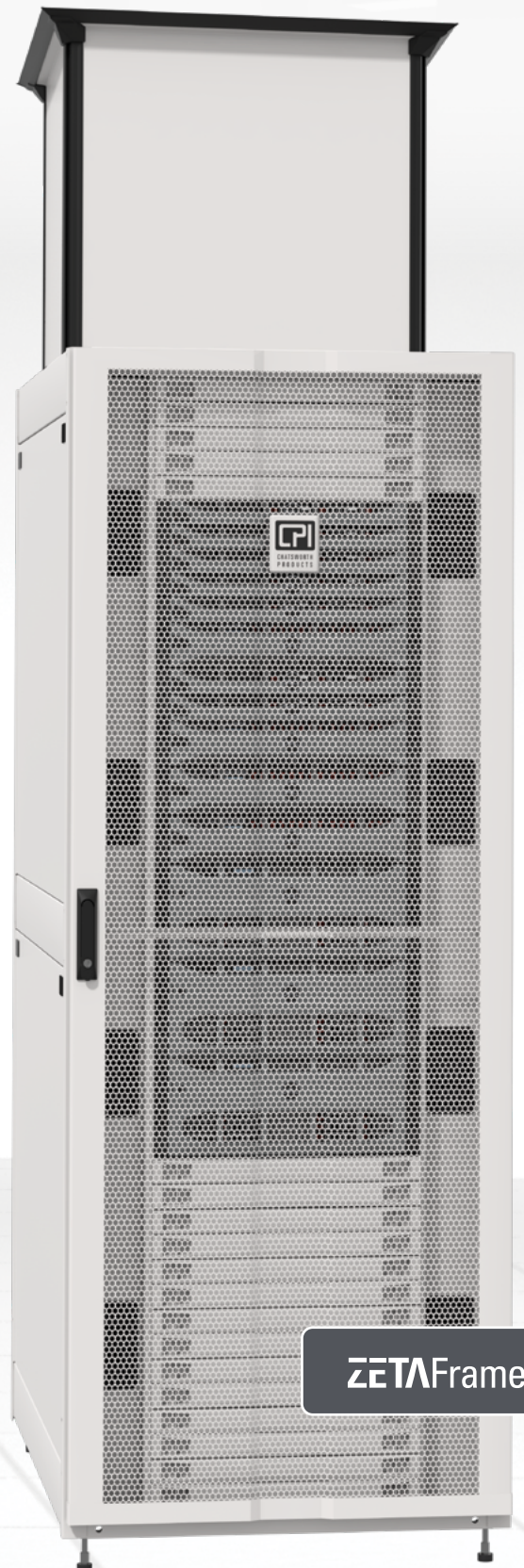

ZETAFrame

Select a Power Distribution Unit

Manage Power with Intelligence

As the last leg of the power chain, power distribution units (PDUs) provide the most granular information needed to understand equipment condition for capacity planning. CPI's eConnect® PDUs help data center managers make informed decisions and have the following features.



Reduced Networking Costs and Complexity



Resistance to High Temperature



Simplified Load Balancing



No Accidental Disconnections



Easy Identification of Failover Unit



Electronic Lock Integration



Gigabit Ethernet



Latest UL Compliance



Cabinet Preinstallation

eConnect

The first step when selecting a rack PDU is to identify the level of functionality. The chart below summarizes the monitoring and control differences.

| | Basic | Metered | Monitored | Monitored Pro | Switched | Switched Pro |
|--------------------------|-------|---------|-----------|---------------|----------|--------------|
| Basic Power Distribution | ✓ | ✓ | ✓ | ✓ | ✓ | ✓ |
| Inlet Metering | | ✓ | ✓ | ✓ | ✓ | ✓ |
| Branch Circuit Metering | | | ✓ | ✓ | ✓ | ✓ |
| Remote Access | | | ✓ | ✓ | ✓ | ✓ |
| Access Control | | | ✓ | ✓ | ✓ | ✓ |
| Outlet Metering | | | | ✓ | | ✓ |
| Switched Outlets | | | | | ✓ | ✓ |

Basic eConnect PDU

Basic Power Distribution

Simple and reliable.

Select Basic eConnect PDUs in low- or high-density applications where no power monitoring is required.

| Basic eConnect PDU, Vertical - North America | | | | | | | | |
|---|----------------|-------------------|----------------|-----------------------------------|-------------------------------|----------------------------|--------------------------------|--------------------|
| Part Number | | | Input Amperage | Input Plug | Outlets | kW Capacity (UL) | Cabinet Capability | |
| Black* | Glacier White* | Redundancy Pack** | | | | | | |
| 120 Volt, Single-Phase Input | | | | | | | | |
| E0-1001-C | E0-1001-E | E0-1001-CE | 20A | C20 Inlet to L5-20 | (24) 5-20 | 1.9 kW | 42U & higher | |
| E0-1002-C | E0-1002-E | E0-1002-CE | 30A | L5-30 | (24) 5-20 | 2.9 kW | 42U & higher | |
| 208 Volt, Single-Phase Input | | | | | | | | |
| E0-1003-C | E0-1003-E | E0-1003-CE | 20A | C20 Inlet to L6-20 | (24) C13 | 3.3 kW | 42U & higher | |
| E0-1004-C | E0-1004-E | E0-1004-CE | 30A | L6-30 | (24) C13 | 5 kW | 42U & higher | |
| E0-1015-C | E0-1015-E | E0-1015-CE | 30A | L6-30 | (36) C13 + (6) C19 | 5 kW | 42U & higher | |
| 208 Volt, Three-Phase Input | | | | | | | | |
| E0-1016-C | E0-1016-E | E0-1016-CE | 30A | L15-30 | (36) C13 + (6) C19 | 8.6 kW | 42U & higher | |
| E0-1007-C | E0-1007-E | E0-1007-CE | 50A | CS8365 | (30) C13 + (12) C19 | 14.4 kW | 42U & higher | |
| E0-1019-C | E0-1019-E | E0-1019-CE | 50A | CS8365 | (36) C13 + (6) C19 | 14.4 kW | 42U & higher | |
| E0-1125-C | E0-1125-E | E0-1125-CE | 50A | CS8365 | (54) C13 | 14.4 kW | 45U & higher | |
| E0-1008-C | E0-1008-E | E0-1008-CE | 60A | IEC 60309 60A 3P+E | (30) C13 + (12) C19 | 17.2 kW | 42U & higher | |
| E0-1020-C | E0-1020-E | E0-1020-CE | 60A | IEC 60309 60A 3P+E | (36) C13 + (6) C19 | 17.2 kW | 42U & higher | |
| E0-1033-C | E0-1033-E | E0-1033-CE | 60A | IEC 60309 60A 3P+E | (12) C13 + (18) C19 | 17.2 kW | 42U & higher | |
| E0-1126-C | E0-1126-E | E0-1126-CE | 60A | IEC 60309 60A 3P+E | (54) C13 | 17.2 kW | 45U & higher | |
| 120/208 Volt, Three-Phase Input | | | | | | | | |
| E0-1013-C | E0-1013-E | E0-1013-CE | 20A | L21-20 | (30) C13 + (6) C19 + (6) 5-20 | 5.7 kW | 42U & higher | |
| E0-1017-C | E0-1017-E | E0-1017-CE | 20A | L21-20 | (36) C13 + (6) C19 | 5.7 kW | 42U & higher | |
| E0-1014-C | E0-1014-E | E0-1014-CE | 30A | L21-30 | (30) C13 + (6) C19 + (6) 5-20 | 8.6 kW | 42U & higher | |
| E0-1018-C | E0-1018-E | E0-1018-CE | 30A | L21-30 | (36) C13 + (6) C19 | 8.6 kW | 42U & higher | |
| 240/415 Volt, Three-Phase Input | | | | | | | | |
| E0-1021-C | E0-1021-E | E0-1021-CE | 30A | L22-30 | (36) C13 + (6) C19 | 17.2 kW | 42U & higher | |
| E0-1127-C | E0-1127-E | E0-1127-CE | 30A | L22-30 | (54) C13 | 17.2 kW | 45U & higher | |
| Basic eConnect PDU, Vertical - Worldwide | | | | | | | | |
| Part Number | | | Input Amperage | Input Plug | Outlets | kW Capacity Worldwide (CE) | kW Capacity North America (UL) | Cabinet Capability |
| Black* | Glacier White* | Redundancy Pack** | | | | | | |
| 220 - 240 Volt, Single-Phase Input | | | | | | | | |
| E0-1005-C | E0-1005-E | E0-1005-CE | 16A | C20 Inlet to IEC 60309 16A 1P+N+E | (24) C13 | 3.8 kW | 3.8 kW | 42U & higher |
| E0-1006-C | E0-1006-E | E0-1006-CE | 32A | IEC 60309 32A 1P+N+E | (24) C13 | 7.7 kW | 6.1 kW | 42U & higher |
| E0-1022-C | E0-1022-E | E0-1022-CE | 32A | IEC 60309 32A 1P+N+E | (36) C13 + (6)C19 | 7.7 kW | 6.1 kW | 42U & higher |
| 220-240/380-415 Volt, Three-Phase Input | | | | | | | | |
| E0-1023-C | E0-1023-E | E0-1023-CE | 16/20A | IEC 60309 16/20A 3P+N+E | (36) C13 + (6) C19 | 11.5 kW | 11.5 kW | 42U & higher |
| E0-1009-C | E0-1009-E | E0-1009-CE | 32A | IEC 60309 32A 3P+N+E | (36) C13 + (12) C19 | 23 kW | 18.4 kW | 42U & higher |
| E0-1024-C | E0-1024-E | E0-1024-CE | 32A | IEC 60309 32A 3P+N+E | (36) C13 + (6) C19 | 23 kW | 18.4 kW | 42U & higher |
| E0-1128-C | E0-1128-E | E0-1128-CE | 32A | IEC 60309 32A 3P+N+E | (54) C13 | 23 kW | 18.4 kW | 45U & higher |

Notes:

* Shipping weight for each unit is 27 lb (12 kg).

**Redundancy Pack includes 2 PDUs (one in Black, one in Glacier White) for easy identification of the primary and secondary unit; shipping weight is 54 lb (24 kg).

Basic eConnect PDU, Horizontal

Simple and reliable.

Use Horizontal eConnect PDUs in applications that require outlets at the top or bottom of cabinets for quick access, low- to medium-density applications that require fewer connections and in distributed infrastructure for edge applications.



| Basic eConnect PDU, Horizontal - North America | | | | | | | | |
|--|----------------|-------------------|----------------|-----------------------------------|-------------------|------------------|--------------------------------|------------------------|
| Part Number | | | Input Amperage | Input Plug | Outlets | kW Capacity (UL) | Form Factor (U) Height | |
| Black* | Glacier White* | Redundancy Pack** | | | | | | |
| 120 Volt, Single-Phase Input | | | | | | | | |
| E0-1243-C | E0-1243-E | E0-1243-CE | 20A | C20 Inlet to L5-20 | (12) 5-20 | 1.9 kW | 1U | |
| E0-1244-C | E0-1244-E | E0-1244-CE | 30A | NEMA L5-30P | (12) 5-20 | 2.9 kW | 1U | |
| 208 Volt, Single-Phase Input | | | | | | | | |
| E0-1245-C | E0-1245-E | E0-1245-CE | 20A | C20 Inlet to L6-20 | (12) C13 | 3.3 kW | 1U | |
| E0-1270-C | E0-1270-E | E0-1270-CE | 20A | C20 Inlet to L6-20 | (8) C13 + (4) C19 | 3.3 kW | 1U | |
| E0-1246-C | E0-1246-E | E0-1246-CE | 30A | NEMA L6-30P | (12) C13 | 5 kW | 1U | |
| E0-1253-C | E0-1253-E | E0-1253-CE | 30A | NEMA L6-30P | (9) C19 | 5 kW | 1U | |
| E0-1271-C | E0-1271-E | E0-1271-CE | 30A | NEMA L6-30P | (8) C13 + (4) C19 | 5 kW | 1U | |
| 120/208 Volt, Three-Phase Input | | | | | | | | |
| E0-1248-C | E0-1248-E | E0-1248-CE | 20A | NEMA L21-20P | (12) C13 | 5.7 kW | 1U | |
| E0-1255-C | E0-1255-E | E0-1255-CE | 20A | NEMA L21-20P | (9) C19 | 5.7 kW | 1U | |
| E0-1273-C | E0-1273-E | E0-1273-CE | 20A | NEMA L21-20P | (8) C13 + (4) C19 | 5.7 kW | 1U | |
| E0-1249-C | E0-1249-E | E0-1249-CE | 30A | NEMA L21-30P | (12) C13 | 8.6 kW | 1U | |
| E0-1256-C | E0-1256-E | E0-1256-CE | 30A | NEMA L21-30P | (9) C19 | 8.6 kW | 1U | |
| E0-1274-C | E0-1274-E | E0-1274-CE | 30A | NEMA L21-30P | (8) C13 + (4) C19 | 8.6 kW | 1U | |
| 208 Volt, Three-Phase Input | | | | | | | | |
| E0-1247-C | E0-1247-E | E0-1247-CE | 30A | NEMA L15-30P | (12) C13 | 8.6 kW | 1U | |
| E0-1254-C | E0-1254-E | E0-1254-CE | 30A | NEMA L15-30P | (9) C19 | 8.6 kW | 1U | |
| E0-1272-C | E0-1272-E | E0-1272-CE | 30A | NEMA L15-30P | (8) C13 + (4) C19 | 8.6 kW | 1U | |
| Basic eConnect PDU, Horizontal - Worldwide | | | | | | | | |
| Part Number | | | Input Amperage | Input Plug | Outlets | kW Capacity (UL) | kW Capacity North America (UL) | Form Factor (U) Height |
| Black* | Glacier White* | Redundancy Pack** | | | | | | |
| 220 - 240 Volt, Single-Phase Input | | | | | | | | |
| E0-1250-C | E0-1250-E | E0-1250-CE | 16A | C20 Inlet to IEC 60309 16A 1P+N+E | (12) C13 | 3.8 kW | 3.8 kW | 1U |
| E0-1275-C | E0-1275-E | E0-1275-CE | 16A | C20 Inlet to IEC 60309 16A 1P+N+E | (8) C13 + (4) C19 | 3.8 kW | 3.8 kW | 1U |
| E0-1252-C | E0-1252-E | E0-1252-CE | 32A | IEC 60309 32A 1P+N+E | (12) C13 | 7.7 kW | 6.1 kW | 1U |
| E0-1257-C | E0-1257-E | E0-1257-CE | 32A | IEC 60309 32A 1P+N+E | (9) C19 | 7.7 kW | 6.1 kW | 1U |
| E0-1277-C | E0-1277-E | E0-1277-CE | 32A | IEC 60309 32A 1P+N+E | (8) C13 + (4) C19 | 7.7 kW | 6.1 kW | 1U |
| 220 - 240/380-415 Volt, Three-Phase Input | | | | | | | | |
| E0-1251-C | E0-1251-E | E0-1251-CE | 16/20A | IEC 60309 16/20A 3P+N+E | (12) C13 | 11.5 kW | 11.5 kW | 1U |
| E0-1258-C | E0-1258-E | E0-1258-CE | 16/20A | IEC 60309 16/20A 3P+N+E | (9) C19 | 11.5 kW | 11.5 kW | 1U |
| E0-1276-C | E0-1276-E | E0-1276-CE | 16/20A | IEC 60309 16/20A 3P+N+E | (8) C13 + (4) C19 | 11.5 kW | 11.5 kW | 1U |

Notes:

*Shipping weight for each unit is 18 lb (8.2 kg).

**Redundancy Pack includes 2 PDUs in Black and Glacier White for easy identification of the primary and secondary unit; shipping weight is 35 lb (15.9 kg)

Basic eConnect PDU, Horizontal

Simple and reliable.

Use Horizontal eConnect PDUs in applications that require outlets at the top or bottom of cabinets for quick access, low- to medium-density applications that require fewer connections and in distributed infrastructure for edge applications.



2U

| Basic eConnect PDU, Horizontal - North America | | | | | | | | | |
|--|----------------|-------------------|----------------|-----------------------------------|-------------------------------|------------------|--------------------------------|------------------------|--|
| Part Number | | | Input Amperage | Input Plug | Outlets | kW Capacity (UL) | Form Factor (U) Height | | |
| Black* | Glacier White* | Redundancy Pack** | | | | | | | |
| 120 Volt, Single-Phase Input | | | | | | | | | |
| E0-1401-C | E0-1401-E | E0-1401-CE | 20A | C20 Inlet to L5-20 | (24) 5-20 | 1.9 kW | 2U | | |
| E0-1402-C | E0-1402-E | E0-1402-CE | 30A | NEMA L5-30P | (24) 5-20 | 2.9 kW | 2U | | |
| 208 Volt, Single-Phase Input | | | | | | | | | |
| E0-1403-C | E0-1403-E | E0-1403-CE | 20A | C20 Inlet to L6-20 | (24) C13 | 3.3 kW | 2U | | |
| E0-1459-C | E0-1459-E | E0-1459-CE | 20A | C20 Inlet to L6-20 | (18) C13 + (6) C19 | 3.3 kW | 2U | | |
| E0-1404-C | E0-1404-E | E0-1404-CE | 30A | NEMA L6-30P | (24) C13 | 5 kW | 2U | | |
| E0-1461-C | E0-1461-E | E0-1461-CE | 30A | NEMA L6-30P | (18) C13 + (6) C19 | 5 kW | 2U | | |
| E0-1478-C | E0-1478-E | E0-1478-CE | 30A | NEMA L6-30P | (6) C13 + (12) C19 | 5 kW | 2U | | |
| 120/208 Volt, Single-Phase Input | | | | | | | | | |
| E0-1469-C | E0-1469-E | E0-1469-CE | 30A | NEMA L14-30P | (12) C13 + (6) C19 + (4) 5-20 | 5 kW | 2U | | |
| 120/208 Volt, Three-Phase Input | | | | | | | | | |
| E0-1439-C | E0-1439-E | E0-1439-CE | 20A | NEMA L21-20P | (24) C13 | 5.7 kW | 2U | | |
| E0-1463-C | E0-1463-E | E0-1463-CE | 20A | NEMA L21-20P | (18) C13 + (6) C19 | 5.7 kW | 2U | | |
| E0-1480-C | E0-1480-E | E0-1480-CE | 20A | NEMA L21-20P | (6) C13 + (12) C19 | 5.7 kW | 2U | | |
| E0-1467-C | E0-1467-E | E0-1467-CE | 20A | NEMA L21-20P | (12) C13 + (6) C19 + (4) 5-20 | 5.7 kW | 2U | | |
| E0-1440-C | E0-1440-E | E0-1440-CE | 30A | NEMA L21-30P | (24) C13 | 8.6 kW | 2U | | |
| E0-1464-C | E0-1464-E | E0-1464-CE | 30A | NEMA L21-30P | (18) C13 + (6) C19 | 8.6 kW | 2U | | |
| E0-1482-C | E0-1482-E | E0-1482-CE | 30A | NEMA L21-30P | (6) C13 + (12) C19 | 8.6 kW | 2U | | |
| E0-1468-C | E0-1468-E | E0-1468-CE | 30A | NEMA L21-30P | (12) C13 + (6) C19 + (4) 5-20 | 8.6 kW | 2U | | |
| 208 Volt, Three-Phase Input | | | | | | | | | |
| E0-1441-C | E0-1441-E | E0-1441-CE | 30A | NEMA L15-30P | (24) C13 | 8.6 kW | 2U | | |
| E0-1465-C | E0-1465-E | E0-1465-CE | 30A | NEMA L15-30P | (18) C13 + (6) C19 | 8.6 kW | 2U | | |
| E0-1483-C | E0-1483-E | E0-1483-CE | 30A | NEMA L15-30P | (6) C13 + (12) C19 | 8.6 kW | 2U | | |
| E0-1484-C | E0-1484-E | E0-1484-CE | 50A | CS8365 | (6) C13 + (12) C19 | 14.4 kW | 2U | | |
| E0-1485-C | E0-1485-E | E0-1485-CE | 60A | IEC 60309 60A 3P+E | (6) C13 + (12) C19 | 17.2 kW | 2U | | |
| Basic eConnect PDU, Horizontal - Worldwide | | | | | | | | | |
| Part Number | | | Input Amperage | Input Plug | Outlets | kW Capacity (UL) | kW Capacity North America (UL) | Form Factor (U) Height | |
| Black* | Glacier White* | Redundancy Pack** | | | | | | | |
| 220 - 240 Volt, Single-Phase Input | | | | | | | | | |
| E0-1405-C | E0-1405-E | E0-1405-CE | 16A | C20 Inlet to IEC 60309 16A 1P+N+E | (24) C13 | 3.8 kW | 3.8 kW | 2U | |
| E0-1460-C | E0-1460-E | E0-1460-CE | 16A | C20 Inlet to IEC 60309 16A 1P+N+E | (18) C13 + (6) C19 | 3.8 kW | 3.8 kW | 2U | |
| E0-1406-C | E0-1406-E | E0-1406-CE | 32A | IEC 60309 32A 1P+N+E | (24) C13 | 7.7 kW | 6.1 kW | 2U | |
| E0-1462-C | E0-1462-E | E0-1462-CE | 32A | IEC 60309 32A 1P+N+E | (18) C13 + (6) C19 | 7.7 kW | 6.1 kW | 2U | |
| E0-1479-C | E0-1479-E | E0-1479-CE | 32A | IEC 60309 32A 1P+N+E | (6) C13 + (12) C19 | 7.7 kW | 6.1 kW | 2U | |
| 220 - 240/380-415 Volt, Three-Phase Input | | | | | | | | | |
| E0-1442-C | E0-1442-E | E0-1442-CE | 16/20A | IEC 60309 16/20A 3P+N+E | (24) C13 | 11.5 kW | 11.5 kW | 2U | |
| E0-1466-C | E0-1466-E | E0-1466-CE | 16/20A | IEC 60309 16/20A 3P+N+E | (18) C13 + (6) C19 | 11.5 kW | 11.5 kW | 2U | |
| E0-1481-C | E0-1481-E | E0-1481-CE | 16/20A | IEC 60309 16/20A 3P+N+E | (6) C13 + (12) C19 | 11.5 kW | 11.5 kW | 2U | |
| E0-1486-C | E0-1486-E | E0-1486-CE | 32A | IEC 60309 32A 3P+N+E | (6) C13 + (12) C19 | 23 kW | 18.4 kW | 2U | |

Notes:

*Shipping weight for each unit is 18 lb (8.2 kg).

**Redundancy Pack includes 2 PDUs in Black and Glacier White for easy identification of the primary and secondary unit; shipping weight is 35 lb (15.9 kg)

Metered eConnect PDU

Safe equipment installation with real-time metering.

Select Metered eConnect PDUs for metering capabilities in non-networked applications.

- Basic Power Distribution
- Inlet Metering

| Metered eConnect PDU, Vertical - North America | | | | | | | | |
|---|----------------|-------------------|----------------|-----------------------------------|-------------------------------|----------------------------|--------------------------------|--------------------|
| Part Number | | | Input Amperage | Input Plug | Outlets | kW Capacity (UL) | Cabinet Capability | |
| Black* | Glacier White* | Redundancy Pack** | | | | | | |
| 120 Volt, Single-Phase Input | | | | | | | | |
| E1-2003-C | E1-2003-E | E1-2003-CE | 20A | C20 Inlet to L6-20 | (24) C13 | 3.3 kW | 42U & higher | |
| E1-2004-C | E1-2004-E | E1-2004-CE | 30A | L6-30 | (24) C13 | 5 kW | 42U & higher | |
| E1-2015-C | E1-2015-E | E1-2015-CE | 30A | L6-30 | (36) C13 + (6) C19 | 5 kW | 42U & higher | |
| 208 Volt, Single-Phase Input | | | | | | | | |
| E1-2003-C | E1-2003-E | E1-2003-CE | 20A | C20 Inlet to L6-20 | (24) C13 | 3.3 kW | 42U & higher | |
| E1-2004-C | E1-2004-E | E1-2004-CE | 30A | L6-30 | (24) C13 | 5 kW | 42U & higher | |
| E1-2015-C | E1-2015-E | E1-2015-CE | 30A | L6-30 | (36) C13 + (6) C19 | 5 kW | 42U & higher | |
| 208 Volt, Three-Phase Input | | | | | | | | |
| E1-2016-C | E1-2016-E | E1-2016-CE | 30A | L15-30 | (36) C13 + (6) C19 | 8.6 kW | 42U & higher | |
| E1-2007-C | E1-2007-E | E1-2007-CE | 50A | CS8365 | (30) C13 + (12) C19 | 14.4 kW | 42U & higher | |
| E1-2019-C | E1-2019-E | E1-2019-CE | 50A | CS8365 | (36) C13 + (6) C19 | 14.4 kW | 42U & higher | |
| E1-2125-C | E1-2125-E | E1-2125-CE | 50A | CS8365 | (54) C13 | 14.4 kW | 45U & higher | |
| E1-2008-C | E1-2008-E | E1-2008-CE | 60A | IEC 60309 60A 3P+E | (30) C13 + (12) C19 | 17.2 kW | 42U & higher | |
| E1-2020-C | E1-2020-E | E1-2020-CE | 60A | IEC 60309 60A 3P+E | (36) C13 + (6) C19 | 17.2 kW | 42U & higher | |
| E1-2126-C | E1-2126-E | E1-2026-CE | 60A | IEC 60309 60A 3P+E | (54) C13 | 17.2 kW | 45U & higher | |
| E1-2033-C | E1-2033-E | E1-2033-CE | 60A | IEC 60309 60A 3P+E | (12) C13 + (18) C19 | 17.2 kW | 42U & higher | |
| 120/208 Volt, Three-Phase Input | | | | | | | | |
| E1-2013-C | E1-2013-E | E1-2013-CE | 20A | L21-20 | (30) C13 + (6) C19 + (6) 5-20 | 5.7 kW | 42U & higher | |
| E1-2017-C | E1-2017-E | E1-2017-CE | 20A | L21-20 | (36) C13 + (6) C19 | 5.7 kW | 42U & higher | |
| E1-2014-C | E1-2014-E | E1-2014-CE | 30A | L21-30 | (30) C13 + (6) C19 + (6) 5-20 | 8.6 kW | 42U & higher | |
| E1-2018-C | E1-2018-E | E1-2018-CE | 30A | L21-30 | (36) C13 + (6) C19 | 8.6 kW | 42U & higher | |
| 240/415 Volt, Three-Phase Input | | | | | | | | |
| E1-2021-C | E1-2021-E | E1-2021-CE | 30A | L22-30 | (36) C13 + (6) C19 | 17.2 kW | 42U & higher | |
| E1-2127-C | E1-2127-E | E1-2127-CE | 30A | L22-30 | (54) C13 | 17.2 kW | 45U & higher | |
| Metered eConnect PDU, Vertical - Worldwide | | | | | | | | |
| Part Number | | | Input Amperage | Input Plug | Outlets | kW Capacity Worldwide (CE) | kW Capacity North America (UL) | Cabinet Capability |
| Black* | Glacier White* | Redundancy Pack** | | | | | | |
| 220 - 240 Volt, Single-Phase Input | | | | | | | | |
| E1-2005-C | E1-2005-E | E1-2005-CE | 16A | C20 Inlet to IEC 60309 16A 1P+N+E | (24) C13 | 3.8 kW | 3.8 kW | 42U & higher |
| E1-2006-C | E1-2006-E | E1-2006-CE | 32A | IEC 60309 32A 1P+N+E | (24) C13 | 7.7 kW | 6.1 kW | 42U & higher |
| E1-2022-C | E1-2022-E | E1-2022-CE | 32A | IEC 60309 32A 1P+N+E | (36) C13 + (6) C19 | 7.7 kW | 6.1 kW | 42U & higher |
| 220-240/380-415 Volt, Three-Phase Input | | | | | | | | |
| E1-2023-C | E1-2023-E | E1-2023-CE | 16/20A | IEC 60309 16/20A 3P+N+E | (36) C13 + (6) C19 | 11.5 kW | 11.5 kW | 42U & higher |
| E1-2009-C | E1-2009-E | E1-2009-CE | 32A | IEC 60309 32A 3P+N+E | (36) C13 + (12) C19 | 23 kW | 18.4 kW | 42U & higher |
| E1-2024-C | E1-2024-E | E1-2024-CE | 32A | IEC 60309 32A 3P+N+E | (36) C13 + (6) C19 | 23 kW | 18.4 kW | 42U & higher |
| E1-2128-C | E1-2128-E | E1-2128-CE | 32A | IEC 60309 32A 3P+N+E | (54) C13 | 23 kW | 18.4 kW | 45U & higher |

Notes:

* Shipping weight for each unit is 27 lb (12 kg).

**Redundancy Pack includes 2 PDUs (one in Black, one in Glacier White) for easy identification of the primary and secondary unit; shipping weight is 54 lb (24 kg).

Monitored eConnect PDU

Robust cabinet-level power management.

Select Monitored eConnect PDUs for remote power monitoring and management to the input and branch circuit level.

- ✓ Basic Power Distribution
- ✓ Inlet Metering
- ✓ Branch Circuit Metering
- ✓ Remote Access
- ✓ Access Control

| Monitored eConnect PDU, Vertical - North America | | | | | | | | |
|--|----------------|-------------------|----------------|-----------------------------------|-------------------------------|----------------------------|--------------------------------|--------------------|
| Part Number | | | Input Amperage | Input Plug | Outlets | kW Capacity (UL) | Cabinet Capability | |
| Black* | Glacier White* | Redundancy Pack** | | | | | | |
| 120 Volt, Single-Phase Input | | | | | | | | |
| EA-3001-C | EA-3001-E | EA-3001-CE | 20A | C20 Inlet to L5-20 | (24) 5-20 | 1.9 kW | 42U & higher | |
| EA-3002-C | EA-3002-E | EA-3002-CE | 30A | L5-30 | (24) 5-20 | 2.9 kW | 42U & higher | |
| 208 Volt, Single-Phase Input | | | | | | | | |
| EA-3003-C | EA-3003-E | EA-3003-CE | 20A | C20 Inlet to L6-20 | (24) C13 | 3.3 kW | 42U & higher | |
| EA-3004-C | EA-3004-E | EA-3004-CE | 30A | L6-30 | (24) C13 | 5 kW | 42U & higher | |
| EA-3015-C | EA-3015-E | EA-3015-CE | 30A | L6-30 | (36) C13 + (6) C19 | 5 kW | 42U & higher | |
| 208 Volt, Three-Phase Input | | | | | | | | |
| EA-3016-C | EA-3016-E | EA-3016-CE | 30A | L15-30 | (36) C13 + (6) C19 | 8.6 kW | 42U & higher | |
| EA-3007-C | EA-3007-E | EA-3007-CE | 50A | CS8365 | (30) C13 + (12) C19 | 14.4 kW | 42U & higher | |
| EA-3019-C | EA-3019-E | EA-3019-CE | 50A | CS8365 | (36) C13 + (6) C19 | 14.4 kW | 42U & higher | |
| EA-3125-C | EA-3125-E | EA-3125-CE | 50A | CS8365 | (54) C13 | 14.4 kW | 45U & higher | |
| EA-3126-C | EA-3126-E | EA-3126-CE | 50A | CS8365 | (54) C13 | 17.2 kW | 45U & higher | |
| EA-3008-C | EA-3008-E | EA-3008-CE | 60A | IEC 60309 60A 3P+E | (30) C13 + (12) C19 | 17.2 kW | 42U & higher | |
| EA-3020-C | EA-3020-E | EA-3020-CE | 60A | IEC 60309 60A 3P+E | (36) C13 + (6) C19 | 17.2 kW | 42U & higher | |
| EA-3033-C | EA-3033-E | EA-3033-CE | 60A | IEC 60309 60A 3P+E | (12) C13 + (18) C19 | 17.2 kW | 42U & higher | |
| 120/208 Volt, Three-Phase Input | | | | | | | | |
| EA-3013-C | EA-3013-E | EA-3013-CE | 20A | L21-20 | (30) C13 + (6) C19 + (6) 5-20 | 5.7 kW | 42U & higher | |
| EA-3017-C | EA-3017-E | EA-3017-CE | 20A | L21-20 | (36) C13 + (6) C19 | 5.7 kW | 42U & higher | |
| EA-3014-C | EA-3014-E | EA-3014-CE | 30A | L21-30 | (30) C13 + (6) C19 + (6) 5-20 | 8.6 kW | 42U & higher | |
| EA-3018-C | EA-3018-E | EA-3018-CE | 30A | L21-30 | (36) C13 + (6) C19 | 8.6 kW | 42U & higher | |
| 240/415 Volt, Three-Phase Input | | | | | | | | |
| EA-3021-C | EA-3021-E | EA-3021-CE | 30A | L22-30 | (36) C13 + (6) C19 | 17.2 kW | 42U & higher | |
| EA-3127-C | EA-3127-E | EA-3127-CE | 30A | L22-30 | (54) C13 | 17.2 kW | 45U & higher | |
| Monitored eConnect PDU, Vertical - Worldwide | | | | | | | | |
| Part Number | | | Input Amperage | Input Plug | Outlets | kW Capacity Worldwide (CE) | kW Capacity North America (UL) | Cabinet Capability |
| Black* | Glacier White* | Redundancy Pack** | | | | | | |
| 220 - 240 Volt, Single-Phase Input | | | | | | | | |
| EA-3005-C | EA-3005-E | EA-3005-CE | 16A | C20 Inlet to IEC 60309 16A 1P+N+E | (24) C13 | 3.8kW | 3.8kW | 42U & higher |
| EA-3006-C | EA-3006-E | EA-3006-CE | 32A | C20 Inlet to IEC 60309 32A 1P+N+E | (24) C13 | 7.7 kW | 6.1 kW | 42U & higher |
| EA-3022-C | EA-3022-E | EA-3022-CE | 32A | C20 Inlet to IEC 60309 32A 1P+N+E | (36) C13 + (6) C19 | 7.7 kW | 6.1 kW | 42U & higher |
| 220-240/380-415 Volt, Three-Phase Input | | | | | | | | |
| EA-3023-C | EA-3023-E | EA-3023-CE | 16/20A | IEC 60309 16/20A 3P+N+E | (36) C13 + (6) C19 | 11.5 kW | 11.5 kW | 42U & higher |
| EA-3009-C | EA-3009-E | EA-3009-CE | 32A | IEC 60309 32A 3P+N+E | (30) C13 + (12) C19 | 23 kW | 18.4 kW | 42U & higher |
| EA-3024-C | EA-3024-E | EA-3024-CE | 32A | IEC 60309 32A 3P+N+E | (36) C13 + (6) C19 | 23 kW | 18.4 kW | 42U & higher |
| EA-3128-C | EA-3128-E | EA-3128-CE | 32A | IEC 60309 20A 3P+N+E | (54) C13 | 23 kW | 18.4 kW | 45U & higher |

Notes:
 * Shipping weight for each unit is 27 lb (12 kg).
 **Redundancy Pack includes 2 PDUs (one in Black, one in Glacier White) for easy identification of the primary and secondary unit; shipping weight is 54 lb (24 kg).

Monitored eConnect PDU, Horizontal

Robust cabinet-level power management.

Use Horizontal eConnect PDUs in applications that require outlets at the top or bottom of cabinets for quick access, low- to medium-density applications that require fewer connections and in distributed infrastructure for edge applications.



| Monitored eConnect PDU, Horizontal - North America | | | | | | | | |
|--|----------------|-------------------|----------------|-----------------------------------|-------------------|------------------|--------------------------------|------------------------|
| Part Number | | | Input Amperage | Input Plug | Outlets | kW Capacity (UL) | Form Factor (U) Height | |
| Black* | Glacier White* | Redundancy Pack** | | | | | | |
| 120 Volt, Single-Phase Input | | | | | | | | |
| EA-3243-C | EA-3243-E | EA-3243-CE | 20A | C20 Inlet to L5-20 | (12) 5-20 | 1.9 kW | 1U | |
| EA-3244-C | EA-3244-E | EA-3244-CE | 30A | NEMA L5-30P | (12) 5-20 | 2.9 kW | 1U | |
| 208 Volt, Single-Phase Input | | | | | | | | |
| EA-3245-C | EA-3245-E | EA-3245-CE | 20A | C20 Inlet to L6-20 | (12) C13 | 3.3 kW | 1U | |
| EA-3270-C | EA-3270-E | EA-3270-CE | 20A | C20 Inlet to L6-20 | (8) C13 + (4) C19 | 3.3 kW | 1U | |
| EA-3246-C | EA-3246-E | EA-3246-CE | 30A | NEMA L6-30P | (12) C13 | 5 kW | 1U | |
| EA-3253-C | EA-3253-E | EA-3253-CE | 30A | NEMA L6-30P | (9) C19 | 5 kW | 1U | |
| EA-3271-C | EA-3271-E | EA-3271-CE | 30A | NEMA L6-30P | (8) C13 + (4) C19 | 5 kW | 1U | |
| 120/208 Volt, Three-Phase Input | | | | | | | | |
| EA-3248-C | EA-3248-E | EA-3248-CE | 20A | NEMA L21-20P | (12) C13 | 5.7 kW | 1U | |
| EA-3255-C | EA-3255-E | EA-3255-CE | 20A | NEMA L21-20P | (9) C19 | 5.7 kW | 1U | |
| EA-3273-C | EA-3273-E | EA-3273-CE | 20A | NEMA L21-20P | (8) C13 + (4) C19 | 5.7 kW | 1U | |
| EA-3249-C | EA-3249-E | EA-3249-CE | 30A | NEMA L21-30P | (12) C13 | 8.6 kW | 1U | |
| EA-3256-C | EA-3256-E | EA-3256-CE | 30A | NEMA L21-30P | (9) C19 | 8.6 kW | 1U | |
| EA-3274-C | EA-3274-E | EA-3274-CE | 30A | NEMA L21-30P | (8) C13 + (4) C19 | 8.6 kW | 1U | |
| 208 Volt, Three-Phase Input | | | | | | | | |
| EA-3247-C | EA-3247-E | EA-3247-CE | 30A | NEMA L15-30P | (12) C13 | 8.6 kW | 1U | |
| EA-3254-C | EA-3254-E | EA-3254-CE | 30A | NEMA L15-30P | (9) C19 | 8.6 kW | 1U | |
| EA-3272-C | EA-3272-E | EA-3272-CE | 30A | NEMA L15-30P | (8) C13 + (4) C19 | 8.6 kW | 1U | |
| Monitored eConnect PDU, Horizontal - Worldwide | | | | | | | | |
| Part Number | | | Input Amperage | Input Plug | Outlets | kW Capacity (UL) | kW Capacity North America (UL) | Form Factor (U) Height |
| Black* | Glacier White* | Redundancy Pack** | | | | | | |
| 220 - 240 Volt, Single-Phase Input | | | | | | | | |
| EA-3250-C | EA-3250-E | EA-3250-CE | 16A | C20 Inlet to IEC 60309 16A 1P+N+E | (12) C13 | 3.8 kW | 3.8 kW | 1U |
| EA-3275-C | EA-3275-E | EA-3275-CE | 16A | C20 Inlet to IEC 60309 16A 1P+N+E | (8) C13 + (4) C19 | 3.8 kW | 3.8 kW | 1U |
| EA-3252-C | EA-3252-E | EA-3252-CE | 32A | IEC 60309 32A 1P+N+E | (12) C13 | 7.7 kW | 6.1 kW | 1U |
| EA-3257-C | EA-3257-E | EA-3257-CE | 32A | IEC 60309 32A 1P+N+E | (9) C19 | 7.7 kW | 6.1 kW | 1U |
| EA-3277-C | EA-3277-E | EA-3277-CE | 32A | IEC 60309 32A 1P+N+E | (8) C13 + (4) C19 | 7.7 kW | 6.1 kW | 1U |
| 220 - 240/380-415 Volt, Three-Phase Input | | | | | | | | |
| EA-3251-C | EA-3251-E | EA-3251-CE | 16/20A | IEC 60309 16/20A 3P+N+E | (12) C13 | 11.5 kW | 11.5 kW | 1U |
| EA-3258-C | EA-3258-E | EA-3258-CE | 16/20A | IEC 60309 16/20A 3P+N+E | (9) C19 | 11.5 kW | 11.5 kW | 1U |
| EA-3276-C | EA-3276-E | EA-3276-CE | 16/20A | IEC 60309 16/20A 3P+N+E | (8) C13 + (4) C19 | 11.5 kW | 11.5 kW | 1U |

Notes:

*Shipping weight for each unit is 18 lb (8.2 kg).

**Redundancy Pack includes 2 PDUs in Black and Glacier White for easy identification of the primary and secondary unit; shipping weight is 35 lb (15.9 kg)

Monitored eConnect PDU, Horizontal

Robust cabinet-level power management.

Use Horizontal eConnect PDUs in applications that require outlets at the top or bottom of cabinets for quick access, low- to medium-density applications that require fewer connections and in distributed infrastructure for edge applications.



2U

| Monitored eConnect PDU, Horizontal - North America | | | | | | | | | |
|--|----------------|-------------------|----------------|-----------------------------------|-------------------------------|------------------|--------------------------------|------------------------|--|
| Part Number | | | Input Amperage | Input Plug | Outlets | kW Capacity (UL) | Form Factor (U) Height | | |
| Black* | Glacier White* | Redundancy Pack** | | | | | | | |
| 120 Volt, Single-Phase Input | | | | | | | | | |
| EA-3401-C | EA-3401-E | EA-3401-CE | 20A | C20 Inlet to L5-20 | (24) 5-20 | 1.9 kW | 2U | | |
| EA-3402-C | EA-3402-E | EA-3402-CE | 30A | NEMA L5-30P | (24) 5-20 | 2.9 kW | 2U | | |
| 208 Volt, Single-Phase Input | | | | | | | | | |
| EA-3403-C | EA-3403-E | EA-3403-CE | 20A | C20 Inlet to L6-20 | (24) C13 | 3.3 kW | 2U | | |
| EA-3459-C | EA-3459-E | EA-3459-CE | 20A | C20 Inlet to L6-20 | (18) C13 + (6) C19 | 3.3 kW | 2U | | |
| EA-3404-C | EA-3404-E | EA-3404-CE | 30A | NEMA L6-30P | (24) C13 | 5 kW | 2U | | |
| EA-3461-C | EA-3461-E | EA-3461-CE | 30A | NEMA L6-30P | (18) C13 + (6) C19 | 5 kW | 2U | | |
| EA-3478-C | EA-3478-E | EA-3478-CE | 30A | NEMA L6-30P | (6) C13 + (12) C19 | 5 kW | 2U | | |
| 120/208 Volt, Single-Phase Input | | | | | | | | | |
| EA-3469-C | EA-3469-E | EA-3469-CE | 30A | NEMA L14-30P | (12) C13 + (6) C19 + (4) 5-20 | 5 kW | 2U | | |
| 120/208 Volt, Three-Phase Input | | | | | | | | | |
| EA-3439-C | EA-3439-E | EA-3439-CE | 20A | NEMA L21-20P | (24) C13 | 5.7 kW | 2U | | |
| EA-3463-C | EA-3463-E | EA-3463-CE | 20A | NEMA L21-20P | (18) C13 + (6) C19 | 5.7 kW | 2U | | |
| EA-3480-C | EA-3480-E | EA-3480-CE | 20A | NEMA L21-20P | (6) C13 + (12) C19 | 5.7 kW | 2U | | |
| EA-3467-C | EA-3467-E | EA-3467-CE | 20A | NEMA L21-20P | (12) C13 + (6) C19 + (4) 5-20 | 5.7 kW | 2U | | |
| EA-3440-C | EA-3440-E | EA-3440-CE | 30A | NEMA L21-30P | (24) C13 | 8.6 kW | 2U | | |
| EA-3464-C | EA-3464-E | EA-3464-CE | 30A | NEMA L21-30P | (18) C13 + (6) C19 | 8.6 kW | 2U | | |
| EA-3482-C | EA-3482-E | EA-3482-CE | 30A | NEMA L21-30P | (6) C13 + (12) C19 | 8.6 kW | 2U | | |
| EA-3468-C | EA-3468-E | EA-3468-CE | 30A | NEMA L21-30P | (12) C13 + (6) C19 + (4) 5-20 | 8.6 kW | 2U | | |
| 208 Volt, Three-Phase Input | | | | | | | | | |
| EA-3441-C | EA-3441-E | EA-3441-CE | 30A | NEMA L15-30P | (24) C13 | 8.6 kW | 2U | | |
| EA-3465-C | EA-3465-E | EA-3465-CE | 30A | NEMA L15-30P | (18) C13 + (6) C19 | 8.6 kW | 2U | | |
| EA-3483-C | EA-3483-E | EA-3483-CE | 30A | NEMA L15-30P | (6) C13 + (12) C19 | 8.6 kW | 2U | | |
| EA-3484-C | EA-3484-E | EA-3484-CE | 50A | CS8365 | (6) C13 + (12) C19 | 14.4 kW | 2U | | |
| EA-3485-C | EA-3485-E | EA-3485-CE | 60A | IEC 60309 60A 3P+E | (6) C13 + (12) C19 | 17.2 kW | 2U | | |
| Monitored eConnect PDU, Horizontal - Worldwide | | | | | | | | | |
| Part Number | | | Input Amperage | Input Plug | Outlets | kW Capacity (UL) | kW Capacity North America (UL) | Form Factor (U) Height | |
| Black* | Glacier White* | Redundancy Pack** | | | | | | | |
| 220 - 240 Volt, Single-Phase Input | | | | | | | | | |
| EA-3405-C | EA-3405-E | EA-3405-CE | 16A | C20 Inlet to IEC 60309 16A 1P+N+E | (24) C13 | 3.8 kW | 3.8 kW | 2U | |
| EA-3460-C | EA-3460-E | EA-3460-CE | 16A | C20 Inlet to IEC 60309 16A 1P+N+E | (18) C13 + (6) C19 | 3.8 kW | 3.8 kW | 2U | |
| EA-3406-C | EA-3406-E | EA-3406-CE | 32A | IEC 60309 32A 1P+N+E | (24) C13 | 7.7 kW | 6.1 kW | 2U | |
| EA-3462-C | EA-3462-E | EA-3462-CE | 32A | IEC 60309 32A 1P+N+E | (18) C13 + (6) C19 | 7.7 kW | 6.1 kW | 2U | |
| EA-3479-C | EA-3479-E | EA-3479-CE | 32A | IEC 60309 32A 1P+N+E | (6) C13 + (12) C19 | 7.7 kW | 6.1 kW | 2U | |
| 220 - 240/380-415 Volt, Three-Phase Input | | | | | | | | | |
| EA-3442-C | EA-3442-E | EA-3442-CE | 16/20A | IEC 60309 16/20A 3P+N+E | (24) C13 | 11.5 kW | 11.5 kW | 2U | |
| EA-3466-C | EA-3466-E | EA-3466-CE | 16/20A | IEC 60309 16/20A 3P+N+E | (18) C13 + (6) C19 | 11.5 kW | 11.5 kW | 2U | |
| EA-3481-C | EA-3481-E | EA-3481-CE | 16/20A | IEC 60309 16/20A 3P+N+E | (6) C13 + (12) C19 | 11.5 kW | 11.5 kW | 2U | |
| EA-3486-C | EA-3486-E | EA-3486-CE | 32A | IEC 60309 32A 3P+N+E | (6) C13 + (12) C19 | 23 kW | 18.4 kW | 2U | |

Notes:

*Shipping weight for each unit is 23 lb (10.4 kg)

**Redundancy Pack includes 2 PDUs in Black and Glacier White for easy identification of the primary and secondary unit; shipping weight is 45 lb (20.4 kg)

Monitored Pro eConnect PDU

Robust and reliable device-level power monitoring.

Select Monitored Pro eConnect PDUs for remote outlet-level power monitoring.

- ✓ Basic Power Distribution
- ✓ Inlet Metering
- ✓ Branch Circuit Metering
- ✓ Remote Access
- ✓ Access Control
- ✓ Outlet Metering

| Monitored Pro eConnect PDU, Vertical - North America | | | | | | | | |
|--|----------------|-------------------|----------------|--------------------|---|------------------|--------------------|--|
| Part Number | | | Input Amperage | Input Plug | Outlets | kW Capacity (UL) | Cabinet Capability | |
| Black* | Glacier White* | Redundancy Pack** | | | | | | |
| 120 Volt, Single-Phase Input | | | | | | | | |
| EA-4001-C | EA-4001-E | EA-4001-CE | 20A | C20 Inlet to L5-20 | (24) 5-20 | 1.9 kW | 42U & higher | |
| EA-4002-C | EA-4002-E | EA-4002-CE | 30A | L5-30 | (24) 5-20 | 2.9 kW | 42U & higher | |
| 208 Volt, Single-Phase Input | | | | | | | | |
| EA-4069-C | EA-4069-E | EA-4069-CE | 20A | C20 Inlet to L6-20 | (18) C13 + (6) C19 | 3.3 kW | 42U & higher | |
| EA-4070-C | EA-4070-E | EA-4070-CE | 20A | C20 Inlet to L6-20 | (24) C13 | 3.3 kW | 42U & higher | |
| EA-4004-C | EA-4004-E | EA-4004-CE | 30A | L6-30 | (24) C13 | 5 kW | 42U & higher | |
| EA-4012-C | EA-4012-E | EA-4012-CE | 30A | L6-30 | (18) C13 + (6) C19 | 5 kW | 42U & higher | |
| 120 - 208 Volt, Three-Phase Input | | | | | | | | |
| EA-4006-C | EA-4006-E | EA-4006-CE | 20A | L21-20 | (24) C13 | 5.7 kW | 42U & higher | |
| EA-4014-C | EA-4014-E | EA-4014-CE | 20A | L21-20 | (18) C13 + (6) C19 | 5.7 kW | 42U & higher | |
| EA-4025-C | EA-4025-E | EA-4025-CE | 20A | L21-20 | (18) C13 + (6) C19 Outlets + (3) 5-20 Convenience Outlets**** | 5.7 kW | 42U & higher | |
| EA-4007-C | EA-4007-E | EA-4007-CE | 30A | L21-30 | (24) C13 | 8.6 kW | 42U & higher | |
| EA-4015-C | EA-4015-E | EA-4015-CE | 30A | L21-30 | (18) C13 + (6) C19 | 8.6 kW | 42U & higher | |
| EA-4026-C | EA-4026-E | EA-4026-CE | 30A | L21-30 | (18) C13 + (6) C19 Outlets + (3) 5-20 Convenience Outlets**** | 8.6 kW | 42U & higher | |
| EA-4035-C | EA-4035-E | EA-4035-CE | 30A | L21-30 | (36) C13 | 8.6 kW | 42U & higher | |
| 208 Volt, Three-Phase Input | | | | | | | | |
| EA-4005-C | EA-4005-E | EA-4005-CE | 30A | L15-30 | (24) C13 | 8.6 kW | 42U & higher | |
| EA-4013-C | EA-4013-E | EA-4013-CE | 30A | L15-30 | (18) C13 + (6) C19 | 8.6 kW | 42U & higher | |
| EA-4034-C | EA-4034-E | EA-4034-CE | 30A | L15-30 | (36) C13 | 8.6 kW | 42U & higher | |
| EA-4016-C | EA-4016-E | EA-4016-CE | 50A | CS8365 | (18) C13 + (6) C19 | 14.4 kW | 42U & higher | |
| EA-4027-C | EA-4027-E | EA-4027-CE | 50A | CS8365 | (12) C13 + (12) C19 | 14.4 kW | 42U & higher | |
| EA-4136-C | EA-4136-E | EA-4136-CE | 50A | CS8365 | (36) C13 | 14.4kW | 45U & higher | |
| EA-4144-C | EA-4144-E | EA-4144-CE | 50A | CS8365 | (24) C13 + (12) C19 | 14.4 kW | 45U & higher | |
| EA-4017-C | EA-4017-E | EA-4017-CE | 60A | IEC 60309 60A 3P+E | (18) C13 + (6) C19 | 17.2 kW | 42U & higher | |
| EA-4028-C | EA-4028-E | EA-4028-CE | 60A | IEC 60309 60A 3P+E | (12) C13 + (12) C19 | 17.2 kW | 42U & higher | |
| EA-4137-C | EA-4137-E | EA-4137-CE | 60A | IEC 60309 60A 3P+E | (36) C13 | 17.2 kW | 45U & higher | |
| EA-4145-C | EA-4145-E | EA-4145-CE | 60A | IEC 60309 60A 3P+E | (24) C13 + (12) C19 | 17.2 kW | 45U & higher | |
| 240/415 Volt, Three-Phase Input | | | | | | | | |
| EA-4018-C | EA-4018-E | EA-4018-CE | 30A | L22-30 | (18) C13 + (6) C19 | 17.2 kW | 42U & higher | |
| EA-4029-C | EA-4029-E | EA-4029-CE | 30A | L22-30 | (12) C13 + (12) C19 | 17.2 kW | 42U & higher | |
| EA-4038-C | EA-4038-E | EA-4038-CE | 30A | L22-30 | (36) C13 | 17.2 kW | 42U & higher | |
| EA-4046-C | EA-4046-E | EA-4046-CE | 30A | L22-30 | (24) C13 + (12) C19 | 17.2 kW | 42U & higher | |

| Metered eConnect PDU, Vertical - Worldwide | | | | | | | | |
|--|----------------|-------------------|----------------|-----------------------------------|---------------------|----------------------------|--------------------------------|--------------------|
| Part Number | | | Input Amperage | Input Plug | Outlets | kW Capacity Worldwide (CE) | kW Capacity North America (UL) | Cabinet Capability |
| Black* | Glacier White* | Redundancy Pack** | | | | | | |
| 220 - 240 Volt, Single-Phase Input | | | | | | | | |
| EA-4008-C | EA-4008-E | EA-4008-CE | 16A | C20 Inlet to IEC 60309 16A 1P+N+E | (24) C13 | 3.8kW | 3.8kW | 42U & higher |
| EA-4019-C | EA-4019-E | EA-4019-CE | 16A | C20 Inlet to IEC 60309 16A 1P+N+E | (18) C13 + (6) C19 | 3.8kW | 3.8kW | 42U & higher |
| EA-4009-C | EA-4009-E | EA-4009-CE | 32A | IEC 60309 32A 1P+N+E | (24) C13 | 7.7 kW | 6.1kW | 42U & higher |
| EA-4020-C | EA-4020-E | EA-4020-CE | 32A | IEC 60309 32A 1P+N+E | (18) C13 + (6) C19 | 7.7 kW | 6.1kW | 42U & higher |
| 220-240/380-415 Volt, Three-Phase Input | | | | | | | | |
| EA-4010-C | EA-4010-E | EA-4010-CE | 16/20A | IEC 60309 16/20A 3P+N+E | (24) C13 | 11.5kW | 11.5kW | 42U & higher |
| EA-4021-C | EA-4021-E | EA-4021-CE | 16/20A | IEC 60309 16/20A 3P+N+E | (18) C13 + (6) C19 | 11.5kW | 11.5kW | 42U & higher |
| EA-4030-C | EA-4030-E | EA-4030-CE | 16/20A | IEC 60309 16/20A 3P+N+E | (12) C13 + (12) C19 | 11.5kW | 11.5kW | 42U & higher |
| EA-4039-C | EA-4039-E | EA-4039-CE | 16/20A | IEC 60309 16/20A 3P+N+E | (36) C13 | 11.5kW | 11.5kW | 42U & higher |
| EA-4047-C | EA-4047-E | EA-4047-CE | 16/20A | IEC 60309 16/20A 3P+N+E | (24) C13 + (12) C19 | 11.5kW | 11.5kW | 42U & higher |
| EA-4022-C | EA-4022-E | EA-4022-CE | 32A | IEC 60309 32A 3P+N+E | (18) C13 + (6) C19 | 23 kW | 18.4kW | 42U & higher |
| EA-4031-C | EA-4031-E | EA-4031-CE | 32A | IEC 60309 32A 3P+N+E | (12) C13 + (12) C19 | 23 kW | 18.4kW | 42U & higher |
| EA-4040-C | EA-4040-E | EA-4040-CE | 32A | IEC 60309 32A 3P+N+E | (36) C13 | 23 kW | 18.4kW | 42U & higher |
| EA-4048-C | EA-4048-E | EA-4048-CE | 32A | IEC 60309 32A 3P+N+E | (24) C13 + (12) C19 | 23 kW | 18.4kW | 42U & higher |

Notes:

* Shipping weight for each unit is 27 lb (12 kg).

**Redundancy Pack includes 2 PDUs (one in Black, one in Glacier White) for easy identification of the primary and secondary unit; shipping weight is 54 lb (24 kg).

***Convenience outlets do not provide monitoring or switching capabilities.

Monitored Pro eConnect PDU, Horizontal

Robust cabinet-level power management.

Use Horizontal eConnect PDUs in applications that require outlets at the top or bottom of cabinets for quick access, low- to medium-density applications that require fewer connections and in distributed infrastructure for edge applications.



| Monitored Pro eConnect PDU, Horizontal - North America | | | | | | | | | |
|--|----------------|-------------------|----------------|-----------------------------------|-------------------|------------------|--------------------------------|------------------------|--|
| Part Number | | | Input Amperage | Input Plug | Outlets | kW Capacity (UL) | Form Factor (U) Height | | |
| Black* | Glacier White* | Redundancy Pack** | | | | | | | |
| 120 Volt, Single-Phase Input | | | | | | | | | |
| EA-4274-C | EA-4274-E | EA-4274-CE | 20A | C20 Inlet to L5-20 | (12) 5-20 | 1.9 kW | 1U | | |
| EA-4275-C | EA-4275-E | EA-4275-CE | 30A | NEMA L5-30P | (12) 5-20 | 2.9 kW | 1U | | |
| 208 Volt, Single-Phase Input | | | | | | | | | |
| EA-4276-C | EA-4276-E | EA-4276-CE | 20A | C20 Inlet to L6-20 | (12) C13 | 3.3 kW | 1U | | |
| EA-4293-C | EA-4293-E | EA-4293-CE | 20A | C20 Inlet to L6-20 | (8) C13 + (4) C19 | 3.3 kW | 1U | | |
| EA-4277-C | EA-4277-E | EA-4277-CE | 30A | NEMA L6-30P | (12) C13 | 5 kW | 1U | | |
| EA-4284-C | EA-4284-E | EA-4284-CE | 30A | NEMA L6-30P | (9) C19 | 5 kW | 1U | | |
| EA-4294-C | EA-4294-E | EA-4294-CE | 30A | NEMA L6-30P | (8) C13 + (4) C19 | 5 kW | 1U | | |
| 120/208 Volt, Three-Phase Input | | | | | | | | | |
| EA-4279-C | EA-4279-E | EA-4279-CE | 20A | NEMA L21-20P | (12) C13 | 5.7 kW | 1U | | |
| EA-4279-C | EA-4279-E | EA-4279-CE | 20A | NEMA L21-20P | (12) C13 | 5.7 kW | 1U | | |
| EA-4296-C | EA-4296-E | EA-4296-CE | 20A | NEMA L21-20P | (8) C13 + (4) C19 | 5.7 kW | 1U | | |
| EA-4280-C | EA-4280-E | EA-4280-CE | 30A | NEMA L21-30P | (12) C13 | 8.6 kW | 1U | | |
| EA-4287-C | EA-4287-E | EA-4287-CE | 30A | NEMA L21-30P | (9) C19 | 8.6 kW | 1U | | |
| EA-4297-C | EA-4297-E | EA-4297-CE | 30A | NEMA L21-30P | (8) C13 + (4) C19 | 8.6 kW | 1U | | |
| 208 Volt, Three-Phase Input | | | | | | | | | |
| EA-4278-C | EA-4278-E | EA-4278-CE | 30A | NEMA L15-30P | (12) C13 | 8.6 kW | 1U | | |
| EA-4285-C | EA-4285-E | EA-4285-CE | 30A | NEMA L15-30P | (9) C19 | 8.6 kW | 1U | | |
| EA-4295-C | EA-4295-E | EA-4295-CE | 30A | NEMA L15-30P | (8) C13 + (4) C19 | 8.6 kW | 1U | | |
| Monitored Pro eConnect PDU, Horizontal - Worldwide | | | | | | | | | |
| Part Number | | | Input Amperage | Input Plug | Outlets | kW Capacity (UL) | kW Capacity North America (UL) | Form Factor (U) Height | |
| Black* | Glacier White* | Redundancy Pack** | | | | | | | |
| 220 - 240 Volt, Single-Phase Input | | | | | | | | | |
| EA-4281-C | EA-4281-E | EA-4281-CE | 16A | C20 Inlet to IEC 60309 16A 1P+N+E | (12) C13 | 3.8 kW | 3.8 kW | 1U | |
| EA-4298-C | EA-4298-E | EA-4298-CE | 16A | C20 Inlet to IEC 60309 16A 1P+N+E | (8) C13 + (4) C19 | 3.8 kW | 3.8 kW | 1U | |
| EA-4283-C | EA-4283-E | EA-4283-CE | 32A | IEC 60309 32A 1P+N+E | (12) C13 | 7.7 kW | 6.1 kW | 1U | |
| EA-4289-C | EA-4289-E | EA-4289-CE | 32A | IEC 60309 32A 1P+N+E | (9) C19 | 7.7 kW | 6.1 kW | 1U | |
| EA-42A0-C | EA-42A0-E | EA-42A0-CE | 32A | IEC 60309 32A 1P+N+E | (8) C13 + (4) C19 | 7.7 kW | 6.1 kW | 1U | |
| 220 - 240/380-415 Volt, Three-Phase Input | | | | | | | | | |
| EA-4282-C | EA-4282-E | EA-4282-CE | 16/20A | IEC 60309 16/20A 3P+N+E | (12) C13 | 11.5 kW | 11.5 kW | 1U | |
| EA-4288-C | EA-4288-E | EA-4288-CE | 16/20A | IEC 60309 16/20A 3P+N+E | (9) C19 | 11.5 kW | 11.5 kW | 1U | |
| EA-4299-C | EA-4299-E | EA-4299-CE | 16/20A | IEC 60309 16/20A 3P+N+E | (8) C13 + (4) C19 | 11.5 kW | 11.5 kW | 1U | |

Notes:

*Shipping weight for each unit is 18 lb (8.2 kg).

**Redundancy Pack includes 2 PDUs in Black and Glacier White for easy identification of the primary and secondary unit; shipping weight is 35 lb (15.9 kg)

Monitored Pro eConnect PDU, Horizontal

Robust cabinet-level power management.

Use Horizontal eConnect PDUs in applications that require outlets at the top or bottom of cabinets for quick access, low- to medium-density applications that require fewer connections and in distributed infrastructure for edge applications.



2U

| Monitored Pro eConnect PDU, Horizontal - North America | | | | | | | | | |
|--|----------------|-------------------|----------------|-----------------------------------|-------------------------------|------------------|--------------------------------|------------------------|--|
| Part Number | | | Input Amperage | Input Plug | Outlets | kW Capacity (UL) | Form Factor (U) Height | | |
| Black* | Glacier White* | Redundancy Pack** | | | | | | | |
| 120 Volt, Single-Phase Input | | | | | | | | | |
| EA-4401-C | EA-4401-E | EA-4401-CE | 20A | C20 Inlet to L5-20 | (24) 5-20 | 1.9 kW | 2U | | |
| EA-4402-C | EA-4402-E | EA-4402-CE | 30A | NEMA L5-30P | (24) 5-20 | 2.9 kW | 2U | | |
| 208 Volt, Single-Phase Input | | | | | | | | | |
| EA-4470-C | EA-4470-E | EA-4470-CE | 20A | C20 Inlet to L6-20 | (24) C13 | 3.3 kW | 2U | | |
| EA-4469-C | EA-4469-E | EA-4469-CE | 20A | C20 Inlet to L6-20 | (18) C13 + (6) C19 | 3.3 kW | 2U | | |
| EA-4404-C | EA-4404-E | EA-4404-CE | 30A | NEMA L6-30P | (24) C13 | 5 kW | 2U | | |
| EA-4412-C | EA-4412-E | EA-4412-CE | 30A | NEMA L6-30P | (18) C13 + (6) C19 | 5 kW | 2U | | |
| EA-44A1-C | EA-44A1-E | EA-44A1-CE | 30A | NEMA L6-30P | (6) C13 + (12) C19 | 5 kW | 2U | | |
| 120/208 Volt, Single-Phase Input | | | | | | | | | |
| EA-4492-C | EA-4492-E | EA-4492-CE | 30A | NEMA L14-30P | (12) C13 + (6) C19 + (4) 5-20 | 5 kW | 2U | | |
| 120/208 Volt, Three-Phase Input | | | | | | | | | |
| EA-4406-C | EA-4406-E | EA-4406-CE | 20A | NEMA L21-20P | (24) C13 | 5.7 kW | 2U | | |
| EA-4414-C | EA-4414-E | EA-4414-CE | 20A | NEMA L21-20P | (18) C13 + (6) C19 | 5.7 kW | 2U | | |
| EA-44A3-C | EA-44A3-E | EA-44A3-CE | 20A | NEMA L21-20P | (6) C13 + (12) C19 | 5.7 kW | 2U | | |
| EA-4490-C | EA-4490-E | EA-4490-CE | 20A | NEMA L21-20P | (12) C13 + (6) C19 + (4) 5-20 | 5.7 kW | 2U | | |
| EA-4407-C | EA-4407-E | EA-4407-CE | 30A | NEMA L21-30P | (24) C13 | 8.6 kW | 2U | | |
| EA-4415-C | EA-4415-E | EA-4415-CE | 30A | NEMA L21-30P | (18) C13 + (6) C19 | 8.6 kW | 2U | | |
| EA-44A5-C | EA-44A5-E | EA-44A5-CE | 30A | NEMA L21-30P | (6) C13 + (12) C19 | 8.6 kW | 2U | | |
| EA-4491-C | EA-4491-E | EA-4491-CE | 30A | NEMA L21-30P | (12) C13 + (6) C19 + (4) 5-20 | 8.6 kW | 2U | | |
| 208 Volt, Three-Phase Input | | | | | | | | | |
| EA-4405-C | EA-4405-E | EA-4405-CE | 30A | NEMA L15-30P | (24) C13 | 8.6 kW | 2U | | |
| EA-4413-C | EA-4413-E | EA-4413-CE | 30A | NEMA L15-30P | (18) C13 + (6) C19 | 8.6 kW | 2U | | |
| EA-44A6-C | EA-44A6-E | EA-44A6-CE | 30A | NEMA L15-30P | (6) C13 + (12) C19 | 8.6 kW | 2U | | |
| EA-44A7-C | EA-44A7-E | EA-44A7-CE | 50A | CS8365 | (6) C13 + (12) C19 | 14.4 kW | 2U | | |
| EA-44A8-C | EA-44A8-E | EA-44A8-CE | 60A | IEC 60309 60A 3P+E | (6) C13 + (12) C19 | 17.2 kW | 2U | | |
| Monitored Pro eConnect PDU, Horizontal - Worldwide | | | | | | | | | |
| Part Number | | | Input Amperage | Input Plug | Outlets | kW Capacity (UL) | kW Capacity North America (UL) | Form Factor (U) Height | |
| Black* | Glacier White* | Redundancy Pack** | | | | | | | |
| 220 - 240 Volt, Single-Phase Input | | | | | | | | | |
| EA-4408-C | EA-4408-E | EA-4408-CE | 16A | C20 Inlet to IEC 60309 16A 1P+N+E | (24) C13 | 3.8 kW | 3.8 kW | 2U | |
| EA-4419-C | EA-4419-E | EA-4419-CE | 16A | C20 Inlet to IEC 60309 16A 1P+N+E | (18) C13 + (6) C19 | 3.8 kW | 3.8 kW | 2U | |
| EA-4409-C | EA-4409-E | EA-4409-CE | 32A | IEC 60309 32A 1P+N+E | (24) C13 | 7.7 kW | 6.1 kW | 2U | |
| EA-4420-C | EA-4420-E | EA-4420-CE | 32A | IEC 60309 32A 1P+N+E | (18) C13 + (6) C19 | 7.7 kW | 6.1 kW | 2U | |
| EA-44A2-C | EA-44A2-E | EA-44A2-CE | 32A | IEC 60309 32A 1P+N+E | (6) C13 + (12) C19 | 7.7 kW | 6.1 kW | 2U | |
| 220 - 240/380-415 Volt, Three-Phase Input | | | | | | | | | |
| EA-4410-C | EA-4410-E | EA-4410-CE | 16/20A | IEC 60309 16/20A 3P+N+E | (24) C13 | 11.5 kW | 11.5 kW | 2U | |
| EA-4421-C | EA-4421-E | EA-4421-CE | 16/20A | IEC 60309 16/20A 3P+N+E | (18) C13 + (6) C19 | 11.5 kW | 11.5 kW | 2U | |
| EA-44A4-C | EA-44A4-E | EA-44A4-CE | 16/20A | IEC 60309 16/20A 3P+N+E | (6) C13 + (12) C19 | 11.5 kW | 11.5 kW | 2U | |
| EA-44A9-C | EA-44A9-E | EA-44A9-CE | 32A | IEC 60309 32A 3P+N+E | (6) C13 + (12) C19 | 23 kW | 18.4 kW | 2U | |

Notes:

*Shipping weight for each unit is 23 lb (10.4 kg)

**Redundancy Pack includes 2 PDUs in Black and Glacier White for easy identification of the primary and secondary unit; shipping weight is 45 lb (20.4 kg)

Switched eConnect PDU

Cabinet-level power management, device-level power control.

Select Switched eConnect PDUs for remote equipment provisioning and sequencing, and to prevent efficiency problems identified during monitoring.

- ✓ Basic Power Distribution
- ✓ Inlet Metering
- ✓ Branch Circuit Metering
- ✓ Remote Access
- ✓ Access Control
- ✓ Switched Outlets

| Switched eConnect PDU, Vertical - North America | | | | | | | | |
|---|----------------|-------------------|----------------|--------------------|--|------------------|--------------------|--|
| Part Number | | | Input Amperage | Input Plug | Outlets | kW Capacity (UL) | Cabinet Capability | |
| Black* | Glacier White* | Redundancy Pack** | | | | | | |
| 120 Volt, Single-Phase Input | | | | | | | | |
| EA-5001-C | EA-5001-E | EA-5001-CE | 20A | C20 Inlet to L5-20 | (24) 5-20 | 1.9 kW | 42U & higher | |
| EA-5002-C | EA-5002-E | EA-5002-CE | 30A | L5-30 | (24) 5-20 | 2.9 kW | 42U & higher | |
| 208 Volt, Single-Phase Input | | | | | | | | |
| EA-5069-C | EA-5069-E | EA-5069-CE | 20A | C20 Inlet to L6-20 | (18) C13 + (6) C19 | 3.3 kW | 42U & higher | |
| EA-5070-C | EA-5070-E | EA-5070-CE | 20A | C20 Inlet to L6-20 | (24) C13 | 3.3 kW | 42U & higher | |
| EA-5004-C | EA-5004-E | EA-5004-CE | 30A | L6-30 | (24) C13 | 5 kW | 42U & higher | |
| EA-5012-C | EA-5012-E | EA-5012-CE | 30A | L6-30 | (18) C13 + (6) C19 | 5 kW | 42U & higher | |
| 120 - 208 Volt, Three-Phase Input | | | | | | | | |
| EA-5006-C | EA-5006-E | EA-5006-CE | 20A | L21-20 | (24) C13 | 5.7 kW | 42U & higher | |
| EA-5014-C | EA-5014-E | EA-5014-CE | 20A | L21-20 | (18) C13 + (6) C19 | 5.7 kW | 42U & higher | |
| EA-5025-C | EA-5025-E | EA-5025-CE | 20A | L21-20 | (18) C13 + (6) C19 Outlets + (3) 5-20 Convenience Outlets*** | 5.7 kW | 42U & higher | |
| EA-5007-C | EA-5007-E | EA-5007-CE | 30A | L21-30 | (24) C13 | 8.6 kW | 42U & higher | |
| EA-5015-C | EA-5015-E | EA-5015-CE | 30A | L21-30 | (18) C13 + (6) C19 | 8.6 kW | 42U & higher | |
| EA-5026-C | EA-5026-E | EA-5026-CE | 30A | L21-30 | (18) C13 + (6) C19 Outlets + (3) 5-20 Convenience Outlets*** | 8.6 kW | 42U & higher | |
| EA-5035-C | EA-5035-E | EA-5035-CE | 30A | L21-30 | (36) C13 | 8.6 kW | 42U & higher | |
| 208 Volt, Three-Phase Input | | | | | | | | |
| EA-5005-C | EA-5005-E | EA-5005-CE | 30A | L15-30 | (24) C13 | 8.6 kW | 42U & higher | |
| EA-5013-C | EA-5013-E | EA-5013-CE | 30A | L15-30 | (18) C13 + (6) C19 | 8.6 kW | 42U & higher | |
| EA-5034-C | EA-5034-E | EA-5034-CE | 30A | L15-30 | (36) C13 | 8.6 kW | 42U & higher | |
| EA-5016-C | EA-5016-E | EA-5016-CE | 50A | CS8365 | (18) C13 + (6) C19 | 14.4 kW | 42U & higher | |
| EA-5027-C | EA-5027-E | EA-5027-CE | 50A | CS8365 | (12) C13 + (12) C19 | 14.4 kW | 42U & higher | |
| EA-5136-C | EA-5136-E | EA-5136-CE | 50A | CS8365 | (36) C13 | 14.4 kW | 45U & higher | |
| EA-5144-C | EA-5144-E | EA-5144-CE | 50A | CS8365 | (24) C13 + (12) C19 | 14.4 kW | 45U & higher | |
| EA-5017-C | EA-5017-E | EA-5017-CE | 60A | IEC 60309 60A 3P+E | (18) C13 + (6) C19 | 17.2 kW | 42U & higher | |
| EA-5028-C | EA-5028-E | EA-5028-CE | 60A | IEC 60309 60A 3P+E | (12) C13 + (12) C19 | 17.2 kW | 42U & higher | |
| EA-5137-C | EA-5137-E | EA-5137-CE | 60A | IEC 60309 60A 3P+E | (36) C13 | 17.2 kW | 45U & higher | |
| EA-5145-C | EA-5145-E | EA-5145-CE | 60A | IEC 60309 60A 3P+E | (24) C13 + (12) C19 | 17.2 kW | 45U & higher | |
| 240/415 Volt, Three-Phase Input | | | | | | | | |
| EA-5018-C | EA-5018-E | EA-5018-CE | 30A | L22-30 | (18) C13 + (6) C19 | 17.2 kW | 42U & higher | |
| EA-5029-C | EA-5029-E | EA-5029-CE | 30A | L22-30 | (12) C13 + (12) C19 | 17.2 kW | 42U & higher | |
| EA-5038-C | EA-5038-E | EA-5038-CE | 30A | L22-30 | (36) C13 | 17.2 kW | 42U & higher | |
| EA-5046-C | EA-5046-E | EA-5046-CE | 30A | L22-30 | (24) C13 + (12) C19 | 17.2 kW | 42U & higher | |

| Switched eConnect PDU, Vertical - Worldwide | | | | | | | | |
|--|----------------|-------------------|----------------|-----------------------------------|---------------------|----------------------------|--------------------------------|--------------------|
| Part Number | | | Input Amperage | Input Plug | Outlets | kW Capacity Worldwide (CE) | kW Capacity North America (UL) | Cabinet Capability |
| Black* | Glacier White* | Redundancy Pack** | | | | | | |
| 220 - 240 Volt, Single-Phase Input | | | | | | | | |
| EA-5008-C | EA-5008-E | EA-5008-CE | 16A | C20 Inlet to IEC 60309 16A 1P+N+E | (24) C13 | 3.8 kW | 3.8 kW | 42U & higher |
| EA-5019-C | EA-5019-E | EA-5019-CE | 16A | C20 Inlet to IEC 60309 16A 1P+N+E | (18) C13 + (6) C19 | 3.8 kW | 3.8 kW | 42U & higher |
| EA-5009-C | EA-5009-E | EA-5009-CE | 32A | IEC 60309 32A 1P+N+E | (24) C13 | 7.7 kW | 6.1 kW | 42U & higher |
| EA-5020-C | EA-5020-E | EA-5020-CE | 32A | IEC 60309 32A 1P+N+E | (18) C13 + (6) C19 | 7.7 kW | 6.1 kW | 42U & higher |
| 220-240/380-415 Volt, Three-Phase Input | | | | | | | | |
| EA-5010-C | EA-5010-E | EA-5010-CE | 16/20A | IEC 60309 16/20A 3P+N+E | (24) C13 | 11.5 kW | 11.5 kW | 42U & higher |
| EA-5021-C | EA-5021-E | EA-5021-CE | 16/20A | IEC 60309 16/20A 3P+N+E | (18) C13 + (6) C19 | 11.5 kW | 11.5 kW | 42U & higher |
| EA-5030-C | EA-5030-E | EA-5030-CE | 16/20A | IEC 60309 16/20A 3P+N+E | (12) C13 + (12) C19 | 11.5 kW | 11.5 kW | 42U & higher |
| EA-5039-C | EA-5039-E | EA-5039-CE | 16/20A | IEC 60309 16/20A 3P+N+E | (36) C13 | 11.5 kW | 11.5 kW | 42U & higher |
| EA-5047-C | EA-5047-E | EA-5047-CE | 16/20A | IEC 60309 16/20A 3P+N+E | (24) C13 + (12) C19 | 11.5 kW | 11.5 kW | 42U & higher |
| EA-5022-C | EA-5022-E | EA-5022-CE | 32A | IEC 60309 32A 3P+N+E | (18) C13 + (6) C19 | 23 kW | 18.4 kW | 42U & higher |
| EA-5031-C | EA-5031-E | EA-5031-CE | 32A | IEC 60309 32A 3P+N+E | (12) C13 + (12) C19 | 23 kW | 18.4 kW | 42U & higher |
| EA-5040-C | EA-5040-E | EA-5040-CE | 32A | IEC 60309 32A 3P+N+E | (36) C13 | 23 kW | 18.4 kW | 42U & higher |
| EA-5048-C | EA-5048-E | EA-5048-CE | 32A | IEC 60309 32A 3P+N+E | (24) C13 + (12) C19 | 23 kW | 18.4 kW | 42U & higher |

Notes:

* Shipping weight for each unit is 27 lb (12 kg).

**Redundancy Pack includes 2 PDUs (one in Black, one in Glacier White) for easy identification of the primary and secondary unit; shipping weight is 54 lb (24 kg).

***Convenience outlets do not provide monitoring or switching capabilities.

Switched Pro eConnect PDU

Device-level power management and control.

Select Switched Pro eConnect PDUs to remotely measure and cycle power for each piece of equipment within the cabinet.

- ✓ Basic Power Distribution
- ✓ Inlet Metering
- ✓ Branch Circuit Metering
- ✓ Remote Access
- ✓ Access Control
- ✓ Outlet Metering
- ✓ Switched Outlets

| Switched Pro eConnect PDU, Vertical - North America | | | | | | | | |
|--|----------------|-------------------|----------------|--------------------------------------|--|----------------------------|--------------------------------|--------------------|
| Part Number | | | Input Amperage | Input Plug | Outlets | kW Capacity (UL) | Cabinet Capability | |
| Black* | Glacier White* | Redundancy Pack** | | | | | | |
| 120 Volt, Single-Phase Input | | | | | | | | |
| EA-6001-C | EA-6001-E | EA-6001-CE | 20A | C20 Inlet to L5-20 | (24) 5-20 | 1.9 kW | 42U & higher | |
| EA-6002-C | EA-6002-E | EA-6002-CE | 30A | L5-30 | (24) 5-20 | 2.9 kW | 42U & higher | |
| 208 Volt, Single-Phase Input | | | | | | | | |
| EA-6069-C | EA-6069-E | EA-6069-CE | 20A | C20 Inlet to L6-20 | (18) C13 + (6) C19 | 3.3 kW | 42U & higher | |
| EA-6070-C | EA-6070-E | EA-6070-CE | 20A | C20 Inlet to L6-20 | (24) C13 | 3.3 kW | 42U & higher | |
| EA-6004-C | EA-6004-E | EA-6004-CE | 30A | L6-30 | (24) C13 | 5 kW | 42U & higher | |
| EA-6012-C | EA-6012-E | EA-6012-CE | 30A | L6-30 | (18) C13 + (6) C19 | 5 kW | 42U & higher | |
| 120 - 208 Volt, Three-Phase Input | | | | | | | | |
| EA-6006-C | EA-6006-E | EA-6006-CE | 20A | L21-20 | (24) C13 | 5.7 kW | 42U & higher | |
| EA-6014-C | EA-6014-E | EA-6014-CE | 20A | L21-20 | (18) C13 + (6) C19 | 5.7 kW | 42U & higher | |
| EA-6025-C | EA-6025-E | EA-6025-CE | 20A | L21-20 | (18) C13 + (6) C19 Outlets + (3) 5-20 Convenience Outlets*** | 5.7 kW | 42U & higher | |
| EA-6007-C | EA-6007-E | EA-6007-CE | 30A | L21-30 | (24) C13 | 8.6 kW | 42U & higher | |
| EA-6015-C | EA-6015-E | EA-6015-CE | 30A | L21-30 | (18) C13 + (6) C19 | 8.6 kW | 42U & higher | |
| EA-6026-C | EA-6026-E | EA-6026-CE | 30A | L21-30 | (18) C13 + (6) C19 Outlets + (3) 5-20 Convenience Outlets*** | 8.6 kW | 42U & higher | |
| EA-6035-C | EA-6035-E | EA-6035-CE | 30A | L21-30 | (36) C13 | 8.6 kW | 42U & higher | |
| 208 Volt, Three-Phase Input | | | | | | | | |
| EA-6005-C | EA-6005-E | EA-6005-CE | 30A | L15-30 | (24) C13 | 8.6 kW | 42U & higher | |
| EA-6013-C | EA-6013-E | EA-6013-CE | 30A | L15-30 | (18) C13 + (6) C19 | 8.6 kW | 42U & higher | |
| EA-6034-C | EA-6034-E | EA-6034-CE | 30A | L15-30 | (36) C13 | 8.6 kW | 42U & higher | |
| EA-6016-C | EA-6016-E | EA-6016-CE | 50A | CS8365 | (18) C13 + (6) C19 | 14.4 kW | 42U & higher | |
| EA-6027-C | EA-6027-E | EA-6027-CE | 50A | CS8365 | (12) C13 + (12) C19 | 14.4 kW | 42U & higher | |
| EA-6136-C | EA-6136-E | EA-6136-CE | 50A | CS8365 | (36) C13 | 14.4 kW | 45U & higher | |
| EA-6144-C | EA-6144-E | EA-6144-CE | 50A | CS8365 | (24) C13 + (12) C19 | 14.4 kW | 45U & higher | |
| EA-6017-C | EA-6017-E | EA-6017-CE | 60A | IEC 60309 60A 3P+E | (18) C13 + (6) C19 | 17.2 kW | 42U & higher | |
| EA-6028-C | EA-6028-E | EA-6028-CE | 60A | IEC 60309 60A 3P+E | (12) C13 + (12) C19 | 17.2 kW | 42U & higher | |
| EA-6137-C | EA-6137-E | EA-6137-CE | 60A | IEC 60309 60A 3P+E | (36) C13 | 17.2 kW | 45U & higher | |
| EA-6145-C | EA-6145-E | EA-6145-CE | 60A | IEC 60309 60A 3P+E | (24) C13 + (12) C19 | 17.2 kW | 45U & higher | |
| 240/415 Volt, Three-Phase Input | | | | | | | | |
| EA-6018-C | EA-6018-E | EA-6018-CE | 30A | L22-30 | (18) C13 + (6) C19 | 17.2 kW | 42U & higher | |
| EA-6029-C | EA-6029-E | EA-6029-CE | 30A | L22-30 | (12) C13 + (12) C19 | 17.2 kW | 42U & higher | |
| EA-6038-C | EA-6038-E | EA-6038-CE | 30A | L22-30 | (36) C13 | 17.2 kW | 42U & higher | |
| EA-6046-C | EA-6046-E | EA-6046-CE | 30A | L22-30 | (24) C13 + (12) C19 | 17.2 kW | 42U & higher | |
| Switched Pro eConnect PDU, Vertical - Worldwide | | | | | | | | |
| Part Number | | | Input Amperage | Input Plug | Outlets | kW Capacity Worldwide (CE) | kW Capacity North America (UL) | Cabinet Capability |
| Black* | Glacier White* | Redundancy Pack** | | | | | | |
| 220 - 240 Volt, Single-Phase Input | | | | | | | | |
| EA-6008-C | EA-6008-E | EA-6008-CE | 16/20A | C20 Inlet to IEC 60309 16/20A 1P+N+E | (24) C13 | 3.8 kW | 3.8 kW | 42U & higher |
| EA-6019-C | EA-6019-E | EA-6019-CE | 16/20A | C20 Inlet to IEC 60309 16/20A 1P+N+E | (18) C13 + (6) C19 | 3.8 kW | 3.8 kW | 42U & higher |
| EA-6009-C | EA-6009-E | EA-6009-CE | 32A | IEC 60309 32A 1P+N+E | (24) C13 | 7.7 kW | 6.1 kW | 42U & higher |
| EA-6020-C | EA-6020-E | EA-6020-CE | 32A | IEC 60309 32A 1P+N+E | (18) C13 + (6) C19 | 7.7 kW | 6.1 kW | 42U & higher |
| 220-240/380-415 Volt, Three-Phase Input | | | | | | | | |
| EA-6010-C | EA-6010-E | EA-6010-CE | 16/20A | IEC 60309 16/20A 3P+N+E | (24) C13 | 11.5 kW | 11.5 kW | 42U & higher |
| EA-6021-C | EA-6021-E | EA-6021-CE | 16/20A | IEC 60309 16/20A 3P+N+E | (18) C13 + (6) C19 | 11.5 kW | 11.5 kW | 42U & higher |
| EA-6030-C | EA-6030-E | EA-6030-CE | 16/20A | IEC 60309 16/20A 3P+N+E | (12) C13 + (12) C19 | 11.5 kW | 11.5 kW | 42U & higher |
| EA-6039-C | EA-6039-E | EA-6039-CE | 16/20A | IEC 60309 16/20A 3P+N+E | (36) C13 | 11.5 kW | 11.5 kW | 42U & higher |
| EA-6047-C | EA-6047-E | EA-6047-CE | 16/20A | IEC 60309 16/20A 3P+N+E | (24) C13 + (12) C19 | 11.5 kW | 11.5 kW | 42U & higher |
| EA-6022-C | EA-6022-E | EA-6022-CE | 32A | IEC 60309 32A 3P+N+E | (18) C13 + (6) C19 | 23 kW | 18.4 kW | 42U & higher |
| EA-6031-C | EA-6031-E | EA-6031-CE | 32A | IEC 60309 32A 3P+N+E | (12) C13 + (12) C19 | 23 kW | 18.4 kW | 42U & higher |
| EA-6040-C | EA-6040-E | EA-6040-CE | 32A | IEC 60309 32A 3P+N+E | (36) C13 | 23 kW | 18.4 kW | 42U & higher |
| EA-6048-C | EA-6048-E | EA-6048-CE | 32A | IEC 60309 32A 3P+N+E | (24) C13 + (12) C19 | 23 kW | 18.4 kW | 42U & higher |

Notes:

* Shipping weight for each unit is 27 lb (12 kg).

**Redundancy Pack includes 2 PDUs (one in Black, one in Glacier White) for easy identification of the primary and secondary unit; shipping weight is 54 lb (24 kg).

***Convenience outlets do not provide monitoring or switching capabilities.

Switched Pro eConnect PDU, Horizontal

Device-level power management and control.

Use Horizontal eConnect PDUs in applications that require outlets at the top or bottom of cabinets for quick access, low- to medium-density applications that require fewer connections and in distributed infrastructure for edge applications.



| Switched Pro eConnect PDU, Horizontal - North America | | | | | | | | |
|---|----------------|-------------------|----------------|-----------------------------------|-------------------|------------------|--------------------------------|------------------------|
| Part Number | | | Input Amperage | Input Plug | Outlets | kW Capacity (UL) | Form Factor (U) Height | |
| Black* | Glacier White* | Redundancy Pack** | | | | | | |
| 120 Volt, Single-Phase Input | | | | | | | | |
| EA-6274-C | EA-6274-E | EA-6274-CE | 20A | C20 Inlet to L5-20 | (12) 5-20 | 1.9 kW | 1U | |
| EA-6275-C | EA-6275-E | EA-6275-CE | 30A | NEMA L5-30P | (12) 5-20 | 2.9 kW | 1U | |
| 208 Volt, Single-Phase Input | | | | | | | | |
| EA-6276-C | EA-6276-E | EA-6276-CE | 20A | C20 Inlet to L6-20 | (12) C13 | 3.3 kW | 1U | |
| EA-6293-C | EA-6293-E | EA-6293-CE | 20A | C20 Inlet to L6-20 | (8) C13 + (4) C19 | 3.3 kW | 1U | |
| EA-6277-C | EA-6277-E | EA-6277-CE | 30A | NEMA L6-30P | (12) C13 | 5 kW | 1U | |
| EA-6284-C | EA-6284-E | EA-6284-CE | 30A | NEMA L6-30P | (9) C19 | 5 kW | 1U | |
| EA-6294-C | EA-6294-E | EA-6294-CE | 30A | NEMA L6-30P | (8) C13 + (4) C19 | 5 kW | 1U | |
| 120/208 Volt, Three-Phase Input | | | | | | | | |
| EA-6279-C | EA-6279-E | EA-6279-CE | 20A | NEMA L21-20P | (12) C13 | 5.7 kW | 1U | |
| EA-6286-C | EA-6286-E | EA-6286-CE | 20A | NEMA L21-20P | (9) C19 | 5.7 kW | 1U | |
| EA-6296-C | EA-6296-E | EA-6296-CE | 20A | NEMA L21-20P | (8) C13 + (4) C19 | 5.7 kW | 1U | |
| EA-6280-C | EA-6280-E | EA-6280-CE | 30A | NEMA L21-30P | (12) C13 | 8.6 kW | 1U | |
| EA-6287-C | EA-6287-E | EA-6287-CE | 30A | NEMA L21-30P | (9) C19 | 8.6 kW | 1U | |
| EA-6297-C | EA-6297-E | EA-6297-CE | 30A | NEMA L21-30P | (8) C13 + (4) C19 | 8.6 kW | 1U | |
| 208 Volt, Three-Phase Input | | | | | | | | |
| EA-6278-C | EA-6278-E | EA-6278-CE | 30A | NEMA L15-30P | (12) C13 | 8.6 kW | 1U | |
| EA-6285-C | EA-6285-E | EA-6285-CE | 30A | NEMA L15-30P | (9) C19 | 8.6 kW | 1U | |
| EA-6295-C | EA-6295-E | EA-6295-CE | 30A | NEMA L15-30P | (8) C13 + (4) C19 | 8.6 kW | 1U | |
| Switched Pro eConnect PDU, Horizontal - Worldwide | | | | | | | | |
| Part Number | | | Input Amperage | Input Plug | Outlets | kW Capacity (UL) | kW Capacity North America (UL) | Form Factor (U) Height |
| Black* | Glacier White* | Redundancy Pack** | | | | | | |
| 220 - 240 Volt, Single-Phase Input | | | | | | | | |
| EA-6281-C | EA-6281-E | EA-6281-CE | 16A | C20 Inlet to IEC 60309 16A 1P+N+E | (12) C13 | 3.8 kW | 3.8 kW | 1U |
| EA-6298-C | EA-6298-E | EA-6298-CE | 16A | C20 Inlet to IEC 60309 16A 1P+N+E | (8) C13 + (4) C19 | 3.8 kW | 3.8 kW | 1U |
| EA-6283-C | EA-6283-E | EA-6283-CE | 32A | IEC 60309 32A 1P+N+E | (12) C13 | 7.7 kW | 6.1 kW | 1U |
| EA-6289-C | EA-6289-E | EA-6289-CE | 32A | IEC 60309 32A 1P+N+E | (9) C19 | 7.7 kW | 6.1 kW | 1U |
| EA-62A0-C | EA-62A0-E | EA-62A0-CE | 32A | IEC 60309 32A 1P+N+E | (8) C13 + (4) C19 | 7.7 kW | 6.1 kW | 1U |
| 220 - 240/380-415 Volt, Three-Phase Input | | | | | | | | |
| EA-6282-C | EA-6282-E | EA-6282-CE | 16/20A | IEC 60309 16/20A 3P+N+E | (12) C13 | 11.5 kW | 11.5 kW | 1U |
| EA-6288-C | EA-6288-E | EA-6288-CE | 16/20A | IEC 60309 16/20A 3P+N+E | (9) C19 | 11.5 kW | 11.5 kW | 1U |
| EA-6299-C | EA-6299-E | EA-6299-CE | 16/20A | IEC 60309 16/20A 3P+N+E | (8) C13 + (4) C19 | 11.5 kW | 11.5 kW | 1U |

Notes:

*Shipping weight for each unit is 18 lb (8.2 kg).

**Redundancy Pack includes 2 PDUs in Black and Glacier White for easy identification of the primary and secondary unit; shipping weight is 35 lb (15.9 kg)

Switched Pro eConnect PDU, Horizontal

Device-level power management and control.

Use Horizontal eConnect PDUs in applications that require outlets at the top or bottom of cabinets for quick access, low- to medium-density applications that require fewer connections and in distributed infrastructure for edge applications.



2U

| Switched Pro eConnect PDU, Horizontal - North America | | | | | | | | | |
|---|----------------|-------------------|----------------|-----------------------------------|-------------------------------|------------------|--------------------------------|------------------------|--|
| Part Number | | | Input Amperage | Input Plug | Outlets | kW Capacity (UL) | Form Factor (U) Height | | |
| Black* | Glacier White* | Redundancy Pack** | | | | | | | |
| 120 Volt, Single-Phase Input | | | | | | | | | |
| EA-6401-C | EA-6401-E | EA-6401-CE | 20A | C20 Inlet to L5-20 | (24) 5-20 | 1.9 kW | | 2U | |
| EA-6402-C | EA-6402-E | EA-6402-CE | 30A | NEMA L5-30P | (24) 5-20 | 2.9 kW | | 2U | |
| 208 Volt, Single-Phase Input | | | | | | | | | |
| EA-6470-C | EA-6470-E | EA-6470-CE | 20A | C20 Inlet to L6-20 | (24) C13 | 3.3 kW | | 2U | |
| EA-6469-C | EA-6469-E | EA-6469-CE | 20A | C20 Inlet to L6-20 | (18) C13 + (6) C19 | 3.3 kW | | 2U | |
| EA-6404-C | EA-6404-E | EA-6404-CE | 30A | NEMA L6-30P | (24) C13 | 5 kW | | 2U | |
| EA-6412-C | EA-6412-E | EA-6412-CE | 30A | NEMA L6-30P | (18) C13 + (6) C19 | 5 kW | | 2U | |
| EA-64A1-C | EA-64A1-E | EA-64A1-CE | 30A | NEMA L6-30P | (6) C13 + (12) C19 | 5 kW | | 2U | |
| 120/208 Volt, Single-Phase Input | | | | | | | | | |
| EA-6492-C | EA-6492-E | EA-6492-CE | 30A | NEMA L14-30P | (12) C13 + (6) C19 + (4) 5-20 | 5 kW | | 2U | |
| 120/208 Volt, Three-Phase Input | | | | | | | | | |
| EA-6406-C | EA-6406-E | EA-6406-CE | 20A | NEMA L21-20P | (24) C13 | 5.7 kW | | 2U | |
| EA-6414-C | EA-6414-E | EA-6414-CE | 20A | NEMA L21-20P | (18) C13 + (6) C19 | 5.7 kW | | 2U | |
| EA-64A3-C | EA-64A3-E | EA-64A3-CE | 20A | NEMA L21-20P | (6) C13 + (12) C19 | 5.7 kW | | 2U | |
| EA-6490-C | EA-6490-E | EA-6490-CE | 20A | NEMA L21-20P | (12) C13 + (6) C19 + (4) 5-20 | 5.7 kW | | 2U | |
| EA-6407-C | EA-6407-E | EA-6407-CE | 30A | NEMA L21-30P | (24) C13 | 8.6 kW | | 2U | |
| EA-6415-C | EA-6415-E | EA-6415-CE | 30A | NEMA L21-30P | (18) C13 + (6) C19 | 8.6 kW | | 2U | |
| EA-64A5-C | EA-64A5-E | EA-64A5-CE | 30A | NEMA L21-30P | (6) C13 + (12) C19 | 8.6 kW | | 2U | |
| EA-6491-C | EA-6491-E | EA-6491-CE | 30A | NEMA L21-30P | (12) C13 + (6) C19 + (4) 5-20 | 8.6 kW | | 2U | |
| 208 Volt, Three-Phase Input | | | | | | | | | |
| EA-6405-C | EA-6405-E | EA-6405-CE | 30A | NEMA L15-30P | (24) C13 | 8.6 kW | | 2U | |
| EA-6413-C | EA-6413-E | EA-6413-CE | 30A | NEMA L15-30P | (18) C13 + (6) C19 | 8.6 kW | | 2U | |
| EA-64A6-C | EA-64A6-E | EA-64A6-CE | 30A | NEMA L15-30P | (6) C13 + (12) C19 | 8.6 kW | | 2U | |
| EA-64A7-C | EA-64A7-E | EA-64A7-CE | 50A | CS8365 | (6) C13 + (12) C19 | 14.4 kW | | 2U | |
| EA-64A8-C | EA-64A8-E | EA-64A8-CE | 60A | IEC 60309 60A 3P+E | (6) C13 + (12) C19 | 17.2 kW | | 2U | |
| Switched Pro eConnect PDU, Horizontal - Worldwide | | | | | | | | | |
| Part Number | | | Input Amperage | Input Plug | Outlets | kW Capacity (UL) | kW Capacity North America (UL) | Form Factor (U) Height | |
| Black* | Glacier White* | Redundancy Pack** | | | | | | | |
| 220 - 240 Volt, Single-Phase Input | | | | | | | | | |
| EA-6408-C | EA-6408-E | EA-6408-CE | 16A | C20 Inlet to IEC 60309 16A 1P+N+E | (24) C13 | 3.8 kW | 3.8 kW | 2U | |
| EA-6419-C | EA-6419-E | EA-6419-CE | 16A | C20 Inlet to IEC 60309 16A 1P+N+E | (18) C13 + (6) C19 | 3.8 kW | 3.8 kW | 2U | |
| EA-6409-C | EA-6409-E | EA-6409-CE | 32A | IEC 60309 32A 1P+N+E | (24) C13 | 7.7 kW | 6.1 kW | 2U | |
| EA-6420-C | EA-6420-E | EA-6420-CE | 32A | IEC 60309 32A 1P+N+E | (18) C13 + (6) C19 | 7.7 kW | 6.1 kW | 2U | |
| EA-64A2-C | EA-64A2-E | EA-64A2-CE | 32A | IEC 60309 32A 1P+N+E | (6) C13 + (12) C19 | 7.7 kW | 6.1 kW | 2U | |
| 220 - 240/380-415 Volt, Three-Phase Input | | | | | | | | | |
| EA-6410-C | EA-6410-E | EA-6410-CE | 16/20A | IEC 60309 16/20A 3P+N+E | (24) C13 | 11.5 kW | 11.5 kW | 2U | |
| EA-6421-C | EA-6421-E | EA-6421-CE | 16/20A | IEC 60309 16/20A 3P+N+E | (18) C13 + (6) C19 | 11.5 kW | 11.5 kW | 2U | |
| EA-64A4-C | EA-64A4-E | EA-64A4-CE | 16/20A | IEC 60309 16/20A 3P+N+E | (6) C13 + (12) C19 | 11.5 kW | 11.5 kW | 2U | |
| EA-64A9-C | EA-64A9-E | EA-64A9-CE | 32A | IEC 60309 32A 3P+N+E | (6) C13 + (12) C19 | 23 kW | 18.4 kW | 2U | |

Notes:

*Shipping weight for each unit is 23 lb (10.4 kg)

**Redundancy Pack includes 2 PDUs in Black and Glacier White for easy identification of the primary and secondary unit; shipping weight is 45 lb (20.4 kg)

Uninterruptible Power Supply (UPS)

Ensure uptime and protect IT assets.

As an integral component of a data center or remote site power chain, the uninterruptible power supply (UPS) provides clean power when AC power is present and provides backup power in the event of a power outage.

Chatsworth Products (CPI), a pioneer of power and infrastructure solutions for the information and communications technology (ICT) and industrial automation segments, offers a full line of 350VA – 10kVA UPS solutions for your power needs, including long-lasting lithium ion battery-based and double-conversion online options yielding industry-leading performance.

Lithium Ion Battery

Ideal for remote sites thanks to longer battery life, faster recharge and more recharge cycles.

Lead Acid Battery

Provides a more cost-effective solution through shorter battery life and longer required charging times.



Lithium Ion Standby UPS 350VA–600VA

This compact design is excellent for use in wall-mount networking and computer equipment cabinets when providing protection to network switches, industrial computers, automation systems, programmable logic controllers (PLCs), video walls, kiosks, and point-of-sale (POS) equipment.

Maintain Uptime

CPI UPS solutions utilize several battery technologies to provide backup power if utility power is interrupted.

Manage Power

As you upgrade wireless networks and deploy more IoT sensors at the edge, you'll need to upgrade networks and add compute and storage closer to operations. CPI's UPS solutions are the proven way to manage power and maintain uptime for remote sites whether powering a single switch or a few racks of compute.

Monitor Remotely

CPI solutions will auto-restart when power is restored after an extended outage. However, it is always wise to remotely monitor power use and conditions of the UPS to ensure performance and reduce site visits.

| Lithium Ion Standby UPS 350VA–600VA | | | | | | | |
|--|-------------|------------|---------------------|--------------------|-------------------|------------------|-------------------------|
| Part Number | Capacity VA | Capacity W | Input Plug* | Outlet Receptacles | Runtime 100% Load | Runtime 50% Load | External Battery Option |
| 120 Volt | | | | | | | |
| LS350A | 350 | 200 | C14 Inlet to 5-15P | (3) 5-15R | 6 | 14 | No |
| LS600A | 600 | 360 | C14 Inlet to 5-15P | (3) 5-15R | 6 | 14 | No |
| 200-240 Volt | | | | | | | |
| LS350B | 350 | 200 | C14 Inlet (no cord) | (2) C13 | 6 | 14 | No |
| LS600B | 600 | 360 | C14 Inlet (no cord) | (2) C13 | 6 | 14 | No |

*On 120 Volt models, included line cord is 3' (0.9 m) long. On 200-240 Volt models, order a line cord separately. C13 to required plug.

Battery Runtimes:

| System Load (W) | Estimated Runtimes On Internal Batteries (mins) | | | | | | | | | |
|-----------------|---|----|----|-----|-----|-----|-----|-----|-----|-----|
| | 20 | 40 | 80 | 120 | 160 | 200 | 240 | 280 | 320 | 360 |
| LS350x | 72 | 35 | 17 | 11 | 9 | 7 | N/A | N/A | N/A | N/A |
| LS600x | 161 | 79 | 35 | 23 | 17 | 14 | 11 | 9 | 8 | 6 |

Note: Runtimes are shown in minutes and will vary based on battery condition, age, cycles and ambient temperature



Lead Acid Line-Interactive UPS 800VA-5000VA

Reliable and economical backup power protection for servers and network applications.

| Lead Acid Line-Interactive UPS 800VA-5000VA | | | | | | | | |
|--|-------------|------------|---------------------|-----------------------------------|----------------------|---------------------|----------------------------|---|
| Part Number | Capacity VA | Capacity W | Input Plug* | Outlet Receptacles | Runtime 100% Load | Runtime 50% Load | External Battery Option | Bypass Distribution Module Compatibility |
| 120 Volt | | | | | | | | |
| VL800A | 800 | 720 | 5-15P | (8) 5-15R | 4 | 11 | No | BDM1A |
| VL1100A | 1100 | 990 | 5-15P | (8) 5-15R | 3 | 11 | No | BDM1A |
| VL1500A | 1500 | 1350 | 5-15P | (8) 5-15R | 4 | 12 | VXBP1 | BDM1A |
| VL2000A | 2000 | 1800 | 5-20P | (8) 5-20R | 4 | 12 | VXBP1 | BDM1B |
| VL2200A | 2200 | 2000 | 5-20P | (8) 5-20R | 4 | 12 | VXBP2 | BDM1B |
| VL3000A | 3000 | 2700 | L5-30P | (8) 5-20R | 4 | 12 | VXBP2 | BDM1D |
| VL3000A-1 | 3000 | 2700 | L5-30P | (1) L5-30R + (6) 5-20R | 4 | 12 | VXBP2 | BDM1D |
| 200-240 Volt* | | | | | | | | |
| VL3000B | 3000 | 2700 | C19 Inlet to L6-20P | (1) C19 + (8) C13 | 3 | 8 | VXBP2 | BDM1C |
| VL5000B | 5000 | 4500 | L6-30P | (1) L6-30R + (4) C19 | 2 | 5 | VXBP3 | No |
| VL5000B-1 | 5000 | 4500 | L6-30P | (2) L6-30R + (2) L6-20R + (1) C19 | 3 | 8 | VXBP3 | No |

**For 120 VAC models, Voltage input is 120 nominal, -32% to +27% range without use of battery. Voltage output is 120 VAC nominal with 100/115/127 VAC selectable output. Line cord is 6' (1.8 m) long.

*For 200-240V models, voltage input is 208/220/230/240 VAC nominal, 162-290 VAC range. Voltage output is 230 VAC nominal with 208/220/230/240 VAC selectable output. Line cord on VL3000B is 8' (2.4 m) long. Other line cords are 6' (1.8 m) long.

Battery Runtimes:

| Battery Runtimes as a Percentage of Full Load | | | | | | | | | | | | | | |
|---|------------------|-------------------------|-----|-----|------|-----------------------|-----|-----|------|------------------------|-----|-----|------|---------------------|
| UPS Part Number | Capacity (Watts) | Internal Batteries Only | | | | With (1) Battery Pack | | | | With (2) Battery Packs | | | | Battery Part Number |
| | | 25% | 50% | 75% | 100% | 25% | 50% | 75% | 100% | 25% | 50% | 75% | 100% | |
| VL800A | 720 | 29 | 11 | 6 | 4 | N/A | N/A | N/A | N/A | N/A | N/A | N/A | N/A | N/A |
| VL1100A | 990 | 26 | 11 | 5 | 3 | N/A | N/A | N/A | N/A | N/A | N/A | N/A | N/A | N/A |
| VL1500A | 1350 | 31 | 12 | 6 | 4 | 124 | 53 | 31 | 22 | 216 | 102 | 61 | 42 | VXBP1 |
| VL2000A | 1800 | 30 | 12 | 6 | 4 | 119 | 50 | 30 | 20 | 211 | 97 | 58 | 40 | VXBP1 |
| VL2200A | 2000 | 32 | 12 | 6 | 4 | 125 | 54 | 32 | 22 | 219 | 104 | 62 | 43 | VXBP2 |
| VL3000A | 2700 | 30 | 12 | 6 | 4 | 119 | 50 | 30 | 20 | 211 | 97 | 58 | 40 | VXBP2 |
| VL3000A-1 | 2700 | 30 | 12 | 6 | 4 | 119 | 50 | 30 | 20 | 211 | 97 | 58 | 40 | VXBP2 |
| VL3000B | 2700 | 13 | 8 | 5 | 3 | 56 | 34 | 24 | 20 | 107 | 66 | 47 | 38 | VXBP3 |
| VL5000B | 4500 | 10 | 5 | 3 | 2 | 38 | 24 | 18 | 14 | 71 | 45 | 33 | 27 | VXBP3 |
| VL5000B-1 | 4500 | 10 | 5 | 3 | 2 | 38 | 24 | 18 | 14 | 71 | 45 | 33 | 27 | VXBP3 |

Battery runtimes shown in minutes and will vary based on battery condition, age, cycles and ambient temperature. Maximum of two external battery packs per UPS.



Lithium Ion Online UPS 1500VA–3000VA

Lithium Ion UPS provides more than twice the life, higher temperature tolerance, longer runtime, and faster recharge when compared to typical lead-acid battery solutions. Double-conversion online technology makes this UPS ideal for protection of network, server, edge, light industrial and distributed IT applications.

| Lithium Ion Online UPS 1500VA–3000VA | | | | | | | |
|---|-------------|------------|---------------------|------------------------|----------------------|---------------------|--|
| Part Number | Capacity VA | Capacity W | Input Plug* | Outlet Receptacles | Runtime 100% Load | Runtime 50% Load | Bypass Distribution Module Compatibility |
| 120 Volt** | | | | | | | |
| LD1500A | 1500 | 1350 | 5-15P | (8) 5-15R | 8 | 19 | BDM1A |
| LD2000A | 2000 | 1800 | 5-20P | (8) 5-20R | 14 | 30 | BDM1B |
| LD3000A | 3000 | 2700 | L5-30P | (1) L5-30P + (6) 5-20R | 11 | 23 | BDM1D |
| LD1500A | 1500 | 1350 | 5-15P | (8) 5-15R | 8 | 19 | BDM1A |
| LD2000A | 2000 | 1800 | 5-20P | (8) 5-20R | 14 | 30 | BDM1B |
| LD3000A | 3000 | 2700 | L5-30P | (1) L5-30P + (6) 5-20R | 11 | 23 | BDM1D |
| 200-240 Volt* | | | | | | | |
| LD1500B | 1500 | 1350 | C14 Inlet to L6-20P | (8) C13 | 8 | 19 | BDM1C |
| LD2000B | 2000 | 1800 | C20 Inlet to L6-20P | (8) C13 | 14 | 30 | BDM1C |
| LD3000B | 3000 | 2700 | C20 Inlet to L6-20P | (1) C19+ (8) C13 | 11 | 23 | BDM1C |

***Voltage input: 55-150 VAC (depending on load level)

**Voltage output: 100/110/115/120/127 VAC selectable. Derate capacity to 80% when output voltage is adjusted to 100 VAC.

**Line cord is 6' (1.8 m) long.

*Voltage input 110-330 VAC (depending on load level)

*Voltage output: 200/208/220/230/240 VAC selectable. Derate capacity to 80% when output voltage is adjusted to 200 or 208 VAC.

*VLine cord is 8' (2.4 m) long.

Battery Runtimes:

| Battery Runtimes as a Percentage of Full Load | | | | | | | | | | |
|---|-----------------|-----|-----|-----|-----|-----|-----|-----|-----|------|
| UPS Part Number | Percentage Load | | | | | | | | | |
| | 10% | 20% | 30% | 40% | 50% | 60% | 70% | 80% | 90% | 100% |
| LD1500X | 111 | 54 | 34 | 25 | 19 | 16 | 13 | 11 | 9 | 8 |
| LD2000X | 163 | 79 | 51 | 38 | 30 | 24 | 21 | 18 | 16 | 14 |
| LD3000X | 127 | 62 | 40 | 29 | 23 | 19 | 16 | 14 | 12 | 11 |

Runtimes are shown in minutes and will vary based on battery condition, age, cycles and ambient temperature.



Lead Acid Online UPS 1000VA–3000VA

Reliable and economical backup power protection for servers and network applications.

| Lead Acid Online UPS 1000VA–3000VA | | | | | | | | |
|---------------------------------------|-------------|------------|---------------------|-----------------------|----------------------|---------------------|----------------------------|---|
| Part Number | Capacity VA | Capacity W | Input Plug* | Outlet Receptacles | Runtime 100% Load | Runtime 50% Load | External Battery Option | Bypass Distribution Module Compatibility |
| 120 Volt** | | | | | | | | |
| VD1000A1U | 1000 | 800 | C14 Inlet to 5-15P | (3) 5-15R | 8 | 20 | No | BDM1A |
| VD1000A | 1000 | 1000 | 5-15P | (8) 5-15R | 3 | 6 | No | BDM1A |
| VD1500A | 1500 | 1450 | 5-15P | (8) 5-15R | 3 | 10 | VXBP4 or VXBP5 | BDM1A |
| VD2000A | 2000 | 1930 | 5-20P | (8) 5-20R | 3 | 10 | VXBP6 | BDM1B |
| VD3000A | 3000 | 2880 | L5-30P | (1)L5-30R + (6) 5-20R | 3 | 10 | VXBP7 | BDM1D |
| 200-240 Volt* | | | | | | | | |
| VD1000B1U | 1000 | 800 | C14 Inlet to L6-20P | (3) C13 | 8 | 20 | No | BDM1C |
| VD1500B | 1500 | 1450 | C14 Inlet to L6-20P | (8) C13 | 3 | 10 | VXBP4 or VXBP5 | BDM1C |
| VD2000B | 2000 | 1930 | C20 Inlet to L6-20P | (8) C13 | 3 | 10 | VXBP6 | BDM1C |
| VD3000B | 3000 | 2880 | C20 Inlet to L6-20P | (1) C19 + (8) C13 | 3 | 10 | VXBP7 | BDM1C |

**For 120 VAC models, Voltage input range is 55-150 VAC (depending on load level). Voltage output is 120 VAC nominal. 2U models support 100/110/115/127 VAC selectable output. Capacities are based on highest selectable voltage. Some models derate at lower voltages.

*For 200-240 VAC models, Voltage input is 208/220/230/240 VAC (depending on load level). Voltage output is 230 VAC nominal. 2U models support 200/208/220/230/240 VAC selectable output.

Capacity derates to 90% at 208 Volts.

Line cord on VD1000A1U is 5' (1.5 m) long, Line cord on other 120 VAC models are 6' (1.8 m) long.

Line cords on 200-240 VAC models are 8' (2.4 m) long.

Battery Runtimes:

| Battery Runtimes as a Percentage of Full Load | | | | | | | | | | | | | | | | | | |
|---|---------------------|-------------------------------|------|---------------------|------|----------------------|------|----------------------|------|----------------------|------|----------------------|------|----------------------|------|----------------------|-----|------------------------|
| UPS Part Number | Capacity (Watts) | Internal Batteries Only | | (1) Battery Pack | | (2) Battery Packs | | (3) Battery Packs | | (4) Battery Packs | | (5) Battery Packs | | (5) Battery Packs | | (5) Battery Packs | | Battery Part Number |
| | | 50% | 100% | 50% | 100% | 50% | 100% | 50% | 100% | 50% | 100% | 50% | 100% | 50% | 100% | | | |
| VD1000A1U | 800 | 20 | 8 | N/A | N/A | N/A | N/A | N/A | N/A | N/A | N/A | N/A | N/A | N/A | N/A | N/A | N/A | N/A |
| VD1000A | 1000 | 6 | 3 | N/A | N/A | N/A | N/A | N/A | N/A | N/A | N/A | N/A | N/A | N/A | N/A | N/A | N/A | N/A |
| VD1500A | 1450 | 10 | 3 | 42 | 17 | 84 | 33 | 120 | 51 | 157 | 72 | 199 | 93 | 244 | 112 | 289 | 128 | VXBP4 |
| VD1500A | 1450 | 10 | 3 | 84 | 33 | 157 | 72 | 244 | 122 | 339 | 146 | N/A | N/A | N/A | N/A | N/A | N/A | VXBP5 |
| VD2000A | 1930 | 10 | 3 | 42 | 17 | 84 | 33 | 121 | 51 | 157 | 72 | 200 | 93 | 244 | 112 | 289 | 128 | VXBP6 |
| VD3000A | 2880 | 10 | 3 | 42 | 17 | 84 | 33 | 121 | 52 | 158 | 73 | 201 | 94 | 246 | 112 | 292 | 129 | VXBP7 |
| VD1000B1U | 800 | 20 | 8 | N/A | N/A | N/A | N/A | N/A | N/A | N/A | N/A | N/A | N/A | N/A | N/A | N/A | N/A | N/A |
| VD1500B | 1450 | 10 | 3 | 42 | 17 | 84 | 33 | 120 | 51 | 157 | 72 | 199 | 93 | 244 | 112 | 289 | 128 | VXBP4 |
| VD1500B | 1450 | 10 | 3 | 84 | 33 | 157 | 72 | 244 | 112 | 339 | 146 | 449 | 189 | 523 | 233 | N/A | N/A | VXBP5 |
| VD2000B | 1930 | 10 | 3 | 42 | 17 | 84 | 33 | 121 | 51 | 157 | 72 | 200 | 93 | 244 | 112 | 290 | 128 | VXBP6 |
| VD3000B | 2880 | 10 | 3 | 42 | 17 | 84 | 33 | 121 | 52 | 158 | 73 | 201 | 94 | 246 | 112 | 292 | 129 | VXBP7 |

Runtimes are shown in minutes and will vary based on battery condition, age, cycles and ambient temperature. Maximum of seven battery packs with Models VD1500x, VD2000x and VD3000x. Note N/A indicates battery pack limit for various UPS and battery pack combinations.

Environmental Monitoring

Monitor the environment proactively.

Monitor temperature and humidity of supply air and exhaust air at the cabinet to ensure proper operating conditions for equipment. Adding or removing equipment — and even adjusting workloads — can change the operating conditions at each cabinet.

If you are using a Monitored, Monitored Pro, Switched or Switched Pro eConnect PDU, you can simply add up to two sensors to each PDU and monitor temperature and humidity with power.



| Temperature and Humidity Sensors | | |
|--|--|-------------------------|
| Part Number | Description | Shipping Weight lb (kg) |
| Sensors that Integrate with eConnect PDU | | |
| 14665-001 | USB Temperature and Humidity Sensor for Monitored, Monitored Pro, Switched or Switched Pro eConnect PDUs | 3 (1.4) |
| Standalone Environmental Monitoring Appliance and Sensors | | |
| 60100-001 | RIM-750, with 4 Temperature/Humidity inputs, Standalone system with separate network connection. | 2 (0.9) |
| 60108-002 | Temperature and Humidity Sensor for RIM-750, RJ11, 25'L (7.6 m) cord | 1 (0.5) |

Quick Tip

If you are using a Basic or Metered PDU, or want a separate appliance or network for monitoring environmental conditions, use the RIM-750 with required sensors to monitor temperature and humidity independent of power.





RFID Electronic Lock

Protect equipment electronically.

Electronic locks make it easy to manage authorized access to cabinets and keep an automated record of each access attempt, while featuring swinghandles with integrated dual-frequency card reader technology.

Power IQ® for eConnect

Optimize systems remotely.

Take your operations a step further with DCIM integration. Power IQ for eConnect allows data center managers to visualize trends of all activities in the room and cabinet in a single screen.

| Temperature and Humidity Sensors | | |
|--|---|-------------------------|
| Part Number | Description | Shipping Weight lb (kg) |
| RFID Electronic Locks that Integrate with eConnect PDUs | | |
| 14666-001 | eConnect® RFID Electronic Lock Kit* for Monitored, Monitored Pro, Switched and Switched Pro eConnect PDUs | 3 (1.4) |
| Standalone RFID Electronic Lock Systems | | |
| 14667-001 | Networked RFID Electronic Lock Kit* Standalone system with separate network connection. | 7 (3.2) |
| 14668-001 | Security System RFID Electronic Lock Kit (Wiegand)* Standalone system, integrates with BMS system | 3 (1.4) |

Note: Use with 125 kHz CSN and/or 13.56 MHz UID RFID cards. Does not support PACs smart cards. See complete list of cards in specifications for RFID Electronic Lock Kits.

| Power IQ for eConnect Software and License, With 1-Year Maintenance Plan | | | |
|--|--------------------|-------------|--------------------|
| Part Number | Number of Licenses | Part Number | Number of Licenses |
| 36603-001 | Up to 10 Devices | 36603-020 | Up to 200 Devices |
| 36603-002 | Up to 20 Devices | 36603-030 | Up to 300 Devices |
| 36603-005 | Up to 50 Devices | 36603-040 | Up to 400 Devices |
| 36603-010 | Up to 100 Devices | 36603-050 | Up to 500 Devices |



ZETAFrame

Support equipment with strength.

In a perfect world, all data center applications would be alike. But this interconnected reality demands a mix of enterprise-owned, cloud-based and edge services. The most efficient approach to simplifying hybrid operations is to rely on a single cabinet design that supports equipment, cable management, airflow management, intelligent power distribution, environmental monitoring, physical security and system optimization.

ZetaFrame® Cabinet is a highly engineered data center cabinet solution that delivers faster built-to-order configurability, industry-leading strength and scalability, regardless of the application. ZetaFrame Cabinet is a total, turnkey solution that integrates with power, cable and thermal management accessories to support next-generation compute.



Speedy Deployment



Fast Selection and Customization



Integrated Bonding



Future-Proof Strength



Enhanced Cable Management



Integrated Airflow Management

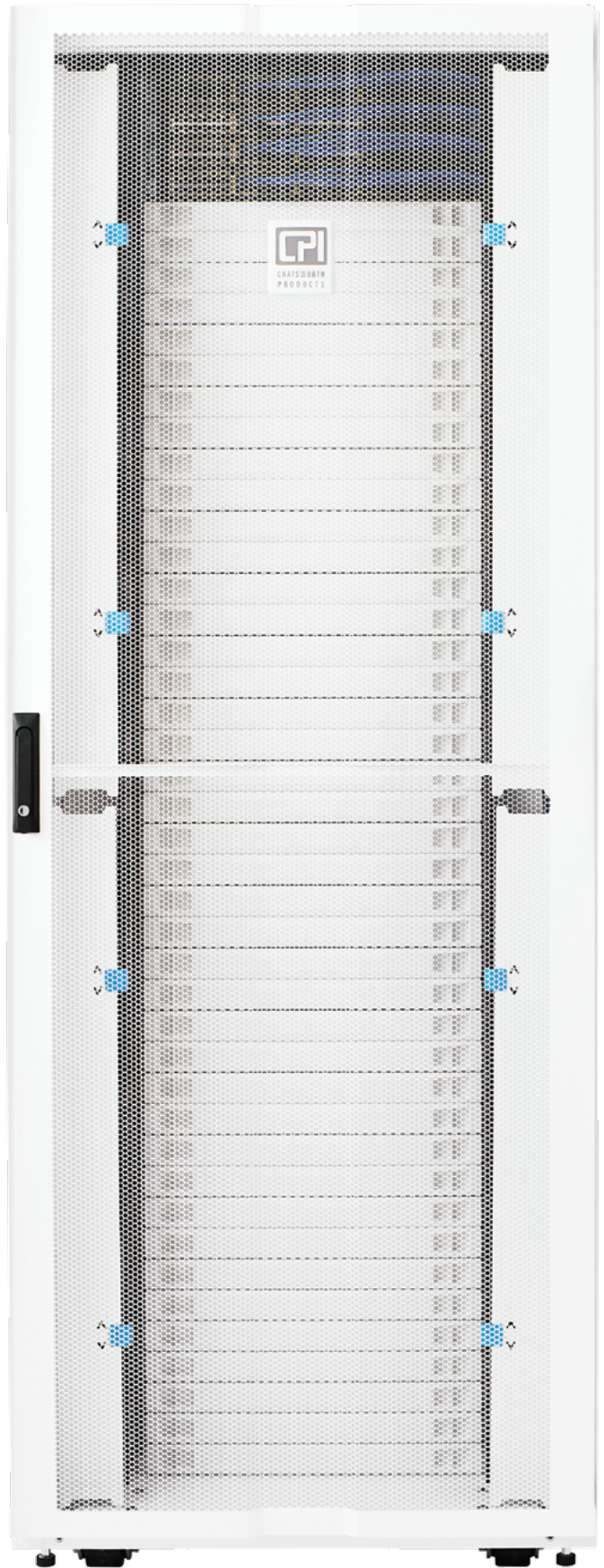

Unlimited Configurability & Speedy Deployment

Highly configurable design makes the ZetaFrame Cabinet the ideal solution for any application.

ZetaFrame delivers fast built-to-order configurability, industry-leading strength and scalability, including the following features and benefits:



Intuitive Cable Management

Simple and efficient cable management. Fast attachment and adjustment of accessories



Robust Construction for Heavy Loads

Roll-formed, tubular and fully welded steel frame



Integrated Bonding

Door hinge and side panel design with integrated bonding



Heavy-Duty Caster Design

Load-bearing casters and easily adjustable leveling feet



Equipment Mounting Rail Brush Kit

Optional brush seal allows quick cabling changes while maintaining disciplined airflow management in wider cabinets. Select Air Dam Kit with brush-sealed rails when ordering your cabinet.

Ships on Standard Pallet or Shock Pallet

Use the part number configurator below to select a standard ZetaFrame Cabinet.

Choose the Height, Width, Depth, Panels, Thermal Configuration and Color. Example part number: ZB45-A120A-E1

Z 1 2 3 - 4 5 6 7 8 - 9 10

| 1. Height | | | |
|-----------|------|------|---|
| U | in | mm | |
| 42 | 79.4 | 2017 | A |
| 45 | 84.6 | 2149 | B |
| 48 | 89.9 | 2283 | C |
| 52 | 96.9 | 2461 | D |

Height includes casters.

| 2. Width | | |
|----------|-----|---|
| in | mm | |
| 23.6 | 600 | 1 |
| 27.6 | 700 | 2 |
| 29.5 | 750 | 3 |
| 31.5 | 800 | 4 |

| 3. Depth | | |
|----------|------|---|
| in | mm | |
| 31.5 | 800 | 1 |
| 39.4 | 1000 | 2 |
| 41.3 | 1050 | 3 |
| 43.3 | 1100 | 4 |
| 47.2 | 1200 | 5 |

Frame depth does not include doors. Doors add approximately 3.1" (79 mm) to overall depth of the cabinet.

| 4. Doors | |
|--|---|
| None | 0 |
| Single Perforated Front/ Double Perforated Rear | A |
| No Front/ Double Perforated Rear | B |

| 5. Top Panel | |
|--------------|----------------|
| 0 | None |
| 1 | Grommet-Sealed |
| 2 | Brush-Sealed |

| 6. Side Panel | |
|---------------|---------|
| 0 | None |
| 1 | 1 Side |
| 2 | 2 Sides |

| 8. Thermal Management | |
|-----------------------|------------------------------|
| 0 | None |
| A | Air Dam |
| B | Air Dam, Brushed-Sealed Rail |

Brush-Sealed Front Rails are not available for 23.6"W (600 mm) cabinets.

| 7. Bottom Panel | |
|-----------------|----------------|
| 0 | None |
| 1 | Grommet-Sealed |
| 2 | Brush-Sealed |

| 9. Color | |
|----------|---------------|
| 7 | Black |
| E | Glacier White |

| 10. Shipping | |
|--------------|-----------------|
| 1 | Standard Pallet |
| 2 | Shock Pallet |

Shock Pallet is available for 42U, 45U, 48U cabinet heights and 43.3"D (1100 mm) and 47.2"D (1200 mm) cabinet depths.

All cabinets ship with two pairs of square-punched equipment mounting rails. Rails for 27.6"W (700 mm) and wider cabinets include four grommet-sealed cable openings (per rail).



Vertical Exhaust Duct Configuration for Front-to-Top Airflow

Use the part number configurator below to create a standard ZetaFrame Cabinet with a Vertical Exhaust Duct. Choose the Height, Width, Depth, Panels, Thermal Configuration and Color. Example part number: ZB45-DB22B-71

Z 1 2 3 - 4 5 6 7 8 - 9 10

| 1. Height | | | |
|-----------|------|------|---|
| U | in | mm | |
| 42 | 79.4 | 2017 | A |
| 45 | 84.6 | 2149 | B |
| 48 | 89.9 | 2283 | C |
| 52 | 96.9 | 2461 | D |

Height includes casters.

| 2. Width | | |
|----------|-----|---|
| in | mm | |
| 23.6 | 600 | 1 |
| 27.6 | 700 | 2 |
| 29.5 | 750 | 3 |
| 31.5 | 800 | 4 |

| 3. Depth | | |
|----------|------|---|
| in | mm | |
| 41.3 | 1050 | 3 |
| 43.3 | 1100 | 4 |
| 47.2 | 1200 | 5 |

Frame depth does not include doors. Doors add approximately 3.1" (79 mm) to overall depth of the cabinet.

| 4. Doors | |
|---|---|
| Single Perforated Front/ Single Solid Rear | D |
| No Front/ Single Solid Rear | E |

| 5. Top Panel | |
|--------------|--|
| A | 15-20" H (381 - 508 mm) Vertical Exhaust Duct |
| B | 20-34" H (508 - 863 mm) Vertical Exhaust Duct |
| C | 34-60" H (863 - 1524 mm) Vertical Exhaust Duct |
| D | 15-20" H (381 - 508 mm) Vertical Exhaust Duct, Air Director |
| E | 20-34" H (508 - 863 mm) Vertical Exhaust Duct, Air Director |
| F | 34-60" H (863 - 1524 mm) Vertical Exhaust Duct, Air Director |

A half brush seal is included at the lower rear of the duct.

| 10. Shipping | |
|--------------|-----------------|
| 1 | Standard Pallet |

| 9. Color | |
|----------|---------------|
| 7 | Black |
| E | Glacier White |

| 8. Thermal Management | |
|-----------------------|------------------------------|
| A | Air Dam |
| B | Air Dam, Brushed-Sealed Rail |

Brush-Sealed Front Rails are not available for 23.6"W (600 mm) cabinets.

| 7. Bottom Panel | |
|-----------------|----------------|
| 0 | None |
| 1 | Grommet-Sealed |
| 2 | Brush-Sealed |

| 6. Side Panel | |
|---------------|---------|
| 0 | None |
| 1 | 1 Side |
| 2 | 2 Sides |

All cabinets ship with two pairs of square-punched equipment mounting rails. Rails for 27.6"W (700 mm) and wider cabinets include four grommet-sealed cable openings (per rail).



Airflow Management for ZetaFrame Cabinet

Control airflow effectively.

ZetaFrame delivers fast built-to-order configurability, industry-leading strength and scalability, including the following features and benefits:

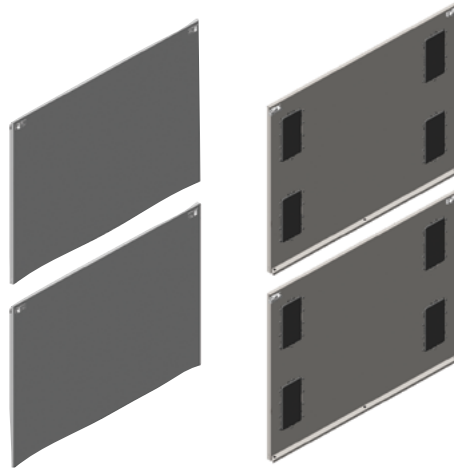

Air Dam Kit

Air Dam blocks airflow around the sides and top of the equipment mounting space, so conditioned air passes through equipment and exhaust air does not recirculate around equipment. Configure with cabinet or order separately.

| Air Dam Kit | | | | | |
|-----------------------------|------------------|------------------|------------------|------------|-------------------------|
| Part Number - Cabinet Width | | | | Height (U) | Shipping Weight lb (kg) |
| 23.6" W (600 mm) | 27.6" W (700 mm) | 29.5" W (750 mm) | 31.5" W (800 mm) | | |
| 38649-X44 | 38649-X55 | 38649-X77 | 38649-X66 | 42 | 11 (5.0) |
| 38649-X47 | 38649-X58 | 38649-X80 | 38649-X69 | 45 | 11 (5.0) |
| 38649-X50 | 38649-X61 | 38649-X83 | 38649-X72 | 48 | 11 (5.0) |
| 38649-X54 | 38649-X65 | 38649-X87 | 38649-X76 | 52 | 12 (5.1) |

Note: X=color: 7=Black, E=Glacier White. Shipping weights are for 800 mm configurations

Side Panels

Two-piece design with top and bottom halves for easier handling. Available in Solid or with Grommets. Configure with cabinet or order separately.

| Side Panels | | | | | | | |
|-------------|---------|-------------|------|------|------|-----------------------------|-------------------------|
| Solid | Grommet | Part Number | | | | Cabinet Frame Depth in (mm) | Shipping Weight lb (kg) |
| | | Height (U) | | | | | |
| | | 42 | 45 | 48 | 52 | | |
| 39763 | 39774 | -X00 | -X51 | -XAC | -XDL | 31.5 (800) | 34 (15.5) |
| | | -X08 | -X59 | -XAL | -XDW | 39.4 (1000) | 41 (18.6) |
| | | -X10 | -X61 | -XAN | -XEA | 41.3 (1050) | 43 (19.1) |
| | | -X12 | -X63 | -XAR | -XEC | 43.3 (1100) | 45 (20.2) |
| | | -X16 | -X67 | -XAW | -XEG | 47.2 (1200) | 48 (21.7) |

Note: X=color: 7=Black, E=Glacier White. Shipping weights are for 52U configurations

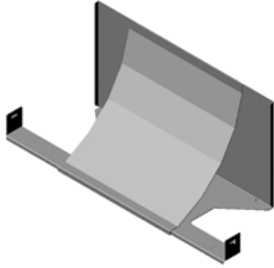

Air Director

Air Director is an angled panel used at the back of cabinets with Vertical Exhaust Duct top panels to guide exhaust air toward the top of the cabinet.

| Air Director | | |
|--------------|------------------------------|-------------------------|
| Part Number | Description | Shipping Weight lb (kg) |
| 39802-X00 | For 23.6"W (600 mm) Cabinets | 12 (5.2) |
| 39802-X01 | For 27.6"W (700 mm) Cabinets | 13 (5.9) |
| 39802-X02 | For 29.5"W (750 mm) Cabinets | 14 (6.2) |
| 39802-X03 | For 31.5"W (800 mm) Cabinets | 15 (6.5) |

Note: X=color: 7=Black, E=Glacier White.



Snap-In Filler Panel

Snap-In Filler Panel blocks airflow in between equipment by sealing unused rack-mount spaces (U) in the cabinet. Use with Air Dam Kit and Bottom Panel to separate cold and hot air within the cabinet.

| Snap-In Filler Panel | | |
|----------------------|------------------------------|-------------------------|
| Part Number | Description | Shipping Weight lb (kg) |
| 34537-X00 | 1U x 19"W (482.6 mm), Single | 14 (6.4) |
| 34537-X01 | 1U x 19"W (482.6 mm), 6 Pack | 14 (6.4) |
| 34538-X00 | 2U x 19"W (482.6 mm), Single | 21 (9.5) |
| 34538-X01 | 2U x 19"W (482.6 mm), 6 Pack | 21 (9.5) |

Note: X=color: 0=Black, E=Glacier White.



Raised Floor Grommets

Raised Floor Grommets provide a reliable seal around cable bundles. Split design allows for retrofitting over existing cable bundles in access floor tiles.

| Raised Floor Grommet | | |
|----------------------|---|-------------------------|
| Part Number | Description | Shipping Weight lb (kg) |
| 13671-001 | Floor Grommet, with Hardware, Single, Black | 2 (1.4) |
| 13671-002 | Floor Grommet, with Hardware, 10 Pack, Black | 18 (8.2) |
| 13874-001 | 4" (102 mm) Round Raised Floor Grommet, with Hardware, Single, Black | 1 (0.5) |
| 13874-002 | 4" (102 mm) Round Raised Floor Grommet, with Hardware, 10 Pack, Black | 6 (2.7) |



Equipment Mounting Rail Grommet Kit

Set of (8) flexible plastic grommets that cover cable openings in the equipment mounting rails. Configure with cabinet or order separately.



Equipment Mounting Rail Brush Kit

Set of (8) brush covers that conceal cable openings in the equipment mounting rails. Configure with cabinet or order separately.

| Equipment Mounting Rail/Grommet Kit | | |
|-------------------------------------|---|-------------------------|
| Part Number | Description | Shipping Weight lb (kg) |
| 39731-001 | Grommet Kit, for 27.6"W (700 mm) and 29.5"W (750 mm) Cabinets; Pack of 8; Black | 2 (0.9) |
| 39731-002 | Grommet Kit, for 31.5"W (800 mm) Cabinet; Pack of 8; Black | 2 (0.9)) |
| 39716-001 | Brush Kit, for 27.6"W (700 mm) and 29.5"W (750 mm) Cabinets; Pack of 8; Black | 2 (0.9) |
| 39716-002 | Brush Kit, for 31.5"W (800 mm) Cabinet; Pack of 8; Black | 3 (1.4) |

Cable Management for ZetaFrame Cabinet

Organize cables with flexibility.

ZetaFrame Cabinet features innovative cable management accessories to provide optimal use of space within the cabinet.

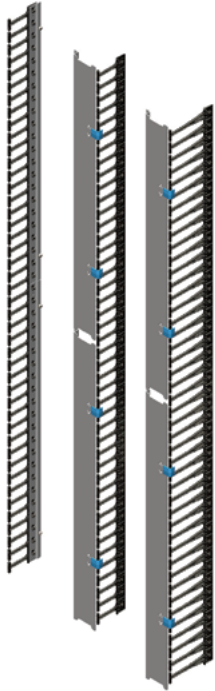

Vertical Cable Manager

Keep network cables separate and organized with long or short fingers while integrating CPI's Air Dam Kit and Cable Lashing Panel for a flexible solution.

| Vertical Cable Manager | | | | | |
|--|------------------|------------------|------------------|------------|-------------------------|
| Part Number - Cabinet Width | | | | Height (U) | Shipping Weight lb (kg) |
| 23.6" W (600 mm) | 27.6" W (700 mm) | 29.5" W (750 mm) | 31.5" W (800 mm) | | |
| Vertical Cable Manager with Long Fingers | | | | | |
| N/A | 38647-X11 | 38647-X22 | 38647-X33 | 42 | 11 (5.0) |
| N/A | 38647-X14 | 38647-X25 | 38647-X36 | 45 | 11 (5.0) |
| N/A | 38647-X17 | 38647-X28 | 38647-X39 | 48 | 11 (5.0) |
| N/A | 38647-X21 | 38647-X32 | 38647-X43 | 52 | 12 (5.1) |
| Vertical Cable Manager with Short Fingers | | | | | |
| 39835-X00 | 38646-X11 | 38646-X22 | 38646-X33 | 42 | 9 (4.1) |
| 39835-X03 | 38646-X14 | 38646-X25 | 38646-X36 | 45 | 10 (4.5) |
| 39835-X06 | 38646-X17 | 38646-X28 | 38646-X39 | 48 | 10 (4.5) |
| 39835-X10 | 38646-X21 | 38646-X32 | 38646-X43 | 52 | 10 (4.5) |

Note: X=Color: 7=Black, E=Glacier White. Shipping weights are for 800 mm configurations.

| Inside Dimensions, Usable Internal Area, Rail Setback, U Opening | | | | | |
|--|---------------|---------------|---|----------------------|--|
| Cabinet Width | Width in (mm) | Depth in (mm) | Cable Area in ² (mm ²) | Rail Setback in (mm) | U Opening in ² (mm ²) |
| Vertical Cable Manager with Long Fingers | | | | | |
| 27.6 (700) | 2.2 (56) | 7.5 (191) | 17.0 (10 967) | 10.1 (257) | 6.6 (460) |
| 29.5 (750) | 3.2 (81) | 7.5 (191) | 24.5 (15 806) | 10.1 (257) | 6.6 (460) |
| 31.5 (800) | 4.2 (107) | 7.5 (191) | 31.9 (20 580) | 10.1 (257) | 6.6 (460) |
| Vertical Cable Manager with Short Fingers | | | | | |
| 23.6 (600) | 0.4 (10) | 5 (127) | 1.8 (1161) | 7.6 (193) | 3.5 (2260) |
| 27.6 (700) | 2.2 (56) | 5 (127) | 11.2 (7225) | 7.6 (193) | 3.5 (2260) |
| 29.5 (750) | 3.2 (81) | 5 (127) | 16.2 (10 451) | 7.6 (193) | 3.5 (2260) |
| 31.5 (800) | 4.2 (107) | 5 (127) | 21.2 (13 677) | 7.6 (193) | 3.5 (2260) |

Rail setback is the minimum distance required between the front edge of the cabinet frame and the front edge of the equipment mounting rail. U opening is the size of the side opening at each U space between T-shaped fingers.



Cable Lashing Panel

Creates simple, vertical pathways for small cable bundles. Patented Cable Bundle Swivels provide quick attachment, removal and adjustment of cable bundles.

| Cable Lashing Panel | | | | |
|---------------------|---------------------------------|----------------|------------|-------------------------|
| Part Number | | | Height (U) | Shipping Weight lb (kg) |
| 2-3/4 (70 mm) | 4.5"W (115 mm) | 7.0"W (178 mm) | | |
| 38634-X00 | 38635-X00 | 38636-X00 | 42 | 13 (5.9) |
| 38634-X03 | 38635-X03 | 38636-X03 | 45 | 14 (6.4) |
| 38634-X06 | 38635-X06 | 38636-X06 | 48 | 15 (6.8) |
| 38634-X10 | 38635-X10 | 38636-X10 | 52 | 16 (7.3) |
| 32657-001 | Cable Bundle Swivel, Pack of 12 | | | 1 (0.5) |

Note: X=Color: 7=Black, E=Glacier White. Shipping weights are for 7"W (178 mm) Lashing Panels.



Front-to-Rear Cable Manager

Attaches to the back of equipment mounting rails wherever there are cable openings, creating a cable pathway between front and rear rails.

| Front-to-Rear Cable Manager | | | | | |
|-----------------------------|-----------------|-----------------|-----------------|--------------------------|-------------------------|
| Part Number - Cabinet Width | | | | Rail Depth Range in (mm) | Shipping Weight lb (kg) |
| 23.6"W (600 mm) | 27.6"W (700 mm) | 29.5"W (750 mm) | 31.5"W (800 mm) | | |
| N/A | 38648-X01 | 38648-X02 | 38648-X03 | 20-32 (508 - 812) | 11 (5.0) |

Note: X=Color: 7=Black, E=Glacier White. Shipping weight is for 800 mm configuration



Full Height PDU Bracket

Accommodate a variety of PDU chassis widths with a full height PDU Bracket, available in Single or Dual options. Use Full Height PDU Bracket to ship or move the cabinet with PDUs installed.

| Full Height PDU Bracket | | | | |
|---------------------------------|-----------------------|---------------|------------|----------------------|
| Part Number - PDU Chassis Width | | | Height (U) | PDU Bracket Capacity |
| 2.2" (56 mm) | 2.4-2.7" (51 - 69 mm) | 4.0" (102 mm) | | |
| 38637-X00 | 38637-X11 | 38638-X00 | 42 | Single |
| 38637-X03 | 38637-X14 | 38638-X03 | 45 | Single |
| 38637-X06 | 38637-X17 | 38638-X06 | 48 | Single |
| 38637-X10 | 38637-X21 | 38638-X10 | 52 | Single |
| 38638-X00 | 38638-X11 | N/A | 42 | Double |
| 38638-X03 | 38638-X14 | N/A | 45 | Double |
| 38638-X06 | 38638-X17 | N/A | 48 | Double |
| 38638-X10 | 38638-X21 | N/A | 52 | Double |

Note: X=Color: 7=Black, E=Glacier White. Shipping weights are for Dual PDU Brackets

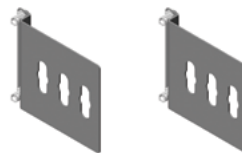

Standard PDU Bracket

Attach to the cabinet frame in either back corner with this easy-solution bracket, which includes one pair of brackets and installation hardware.

| Standard PDU Bracket | | |
|----------------------|----------------|-------------------------|
| Part Number | Description | Shipping Weight lb (kg) |
| 38645-700 | 2-Piece, Black | 2 (0.9) |

Note: One Standard PDU Bracket is included with each ZetaFrame Cabinet.



**CHATSWORTH
PRODUCTS**

United States & Canada

Simi Valley, CA
800-834-4969
Toronto, Ontario, Canada
+905-850-7770
[chatsworth.com](https://www.chatsworth.com)

Latin America

Mexico City, Mexico
+52-55-5203-7525
Toll Free within Mexico
01-800-201-7592
[chatsworth.com.co](https://www.chatsworth.com.co)

Europe

Buckinghamshire, England, UK
+44-1628-524-834
[chatsworth.com](https://www.chatsworth.com)

Middle East & Africa

Dubai, UAE
+971-4-2602125
Doha, Qatar
+974-4-4267422
[chatsworth.com](https://www.chatsworth.com)

Asia Pacific

Jing'an District, Shanghai, China
+86 21 6880-0266
[chatsworth.com.cn](https://www.chatsworth.com.cn)

Find more information
about CPI solutions at:
[chatsworth.com](https://www.chatsworth.com)

+1-800-834-4969 (U.S. & Canada)
or techsupport@chatsworth.com

Manufacturing Capability and Global Availability

Headquartered in the United States, CPI operates from multiple sites worldwide, including offices in Mexico, Canada, China, the Middle East and the United Kingdom. CPI's manufacturing facilities are located in the United States, Asia and Europe.

Standard products are readily available through a global network of industry-leading distributors. With stock availability, and CPI's consistently short factory lead times, you can be assured that CPI solutions will be accessible to meet your project scheduling needs.

How to Buy

CPI sales are conducted in partnership with a global network of distributors, contractors and resellers to ensure a high level of stock availability. Use CPI's Online Catalog to place an order with a distributor near you. Go to [chatsworth.com](https://www.chatsworth.com) to learn more.

About CPI

CPI, a 100% employee-owned company, was founded in June 1991, when 90 workers joined together and purchased the Dracon Division of Harris Corporation using an Employee Stock Ownership Plan (ESOP). Employee ownership is central to the success of CPI. Employee owners are committed to a philosophy of quality through teamwork, caring and commitment, which are extended to customers through our solutions and services.



All products quoted are subject to availability based on manufacturing capacity and shipping dates should be considered estimates only. While every effort has been made to ensure the accuracy of all information, CPI does not accept liability for any errors or omissions and reserves the right to change information and descriptions of listed services and products.

©2023 Chatsworth Products, Inc. All rights reserved. Chatsworth Products, Klik-Nut, CPI, CPI Passive Cooling, CUBE-IT, Secure Array, eConnect, Evolution, GlobalFrame, MegaFrame, QuadraRack, RMR, Saf-T-Grip, SeismicFrame, SlimFrame, TeraFrame, Motive, EuroFrame, Velocity and ZetaFrame are federally registered trademarks of Chatsworth Products. H-Plane, Hi-Bar, In-Plane, M-Frame, NetPoint, Oberon, Simply Efficient, Skybar, and Wi-Tile and are trademarks of Chatsworth Products. All other trademarks belong to their respective companies. Published Rev.3 06/23 MKT-60020-750

[chatsworth.com](https://www.chatsworth.com)